

AGRA®



LIGHTING COLUMNS LED LUMINAIRES FLAGPOLES FLAGS

AGRA is a Polish company specialized in the manufacture of aluminium and fibreglass flagpoles. Over 20+ years of our market presence, we have been able to gain extensive experience in producing composite poles, which has led us to launching our lighting columns.

We provide our customers with complete outdoor lighting solutions (lighting columns with LED luminaires).

Our products are of highest quality, weather-proof, compliant with applicable standards and manufactured using established procedures.

We are a reliable company whose products are known not only in Poland, but also in other countries.

When you choose our company, you will receive not only high-end products, but also advice and full support even for the toughest of implementation tasks.

Product List

01	Composite lighting columns	4
02	Precasts	8
03	Accessories	10
04	Street lighting luminaires	12
05	Floodlights	24
06	Modern luminaires	26
07	Garden & park luminaires	36
08	Heritage luminaires	44
09	Fibreglass flagpoles	54
10	Aluminium flagpoles	62
11	ECO aluminium flagpoles	70
12	Telescoping flagpole	76
13	Symbols	78



01

Composite Lighting Columns

A lighting column made of polymer composite is an innovation on the Polish market. By combining modern materials such as polyester resins, textiles and glass mats, we have obtained a lightweight and durable product.

The production of composite columns is environmentally friendly as its CO2 emissions are very low and fibreglass columns are 100% recyclable.

They offer an alternative to metal and concrete poles.

Main features of the composite:

- longevity (40-50 years)
- weather-proof - corrosion-free
- more durable than aluminium, steel and wood
- tensile and bending strength
- non conductive
- quick to install and dismantle
- easy to transport

Innovative composite columns equipped with modern LED luminaires are the most energy-saving and versatile of general lighting technologies. They can be used in power engineering (e.g. to transmit electricity, arrest lightnings, etc.), in road construction (as traffic control signs and bollards) and for the lighting of roads and motorways, car parks as well as retail and sports facilities.

**Colouring:
Any RAL colour.**

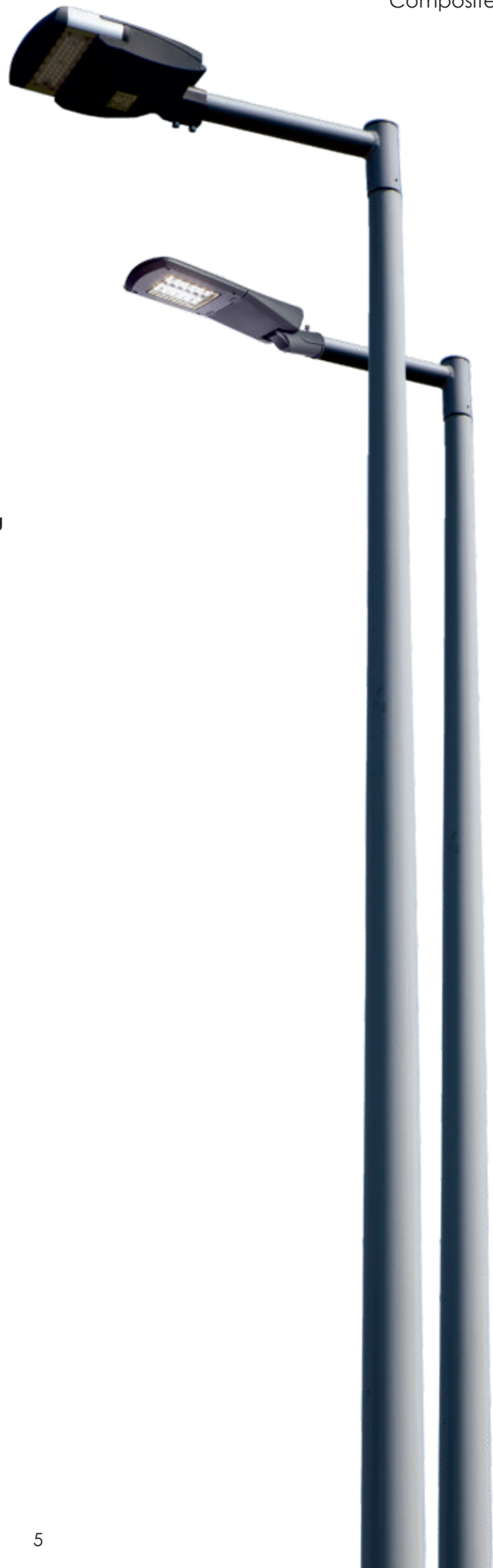

Flange Plate Mounted



Composite Lighting Column

The column is made of polyester glass laminate based on polyester resins and reinforced with fibreglass mat and fabric.

The structural fibres transmit compressive and tensile stresses, whereas the bonding substance transmits shearing forces, ensuring, as a connector, fibre-to-fibre mating. The weight content of fibres is not lower than 40%.

a x b - door aperture dimensions:
(200x75; 300x85; 400x85)

H - composite column height

D - composite column base diameter



Flush door (PC + ABS)

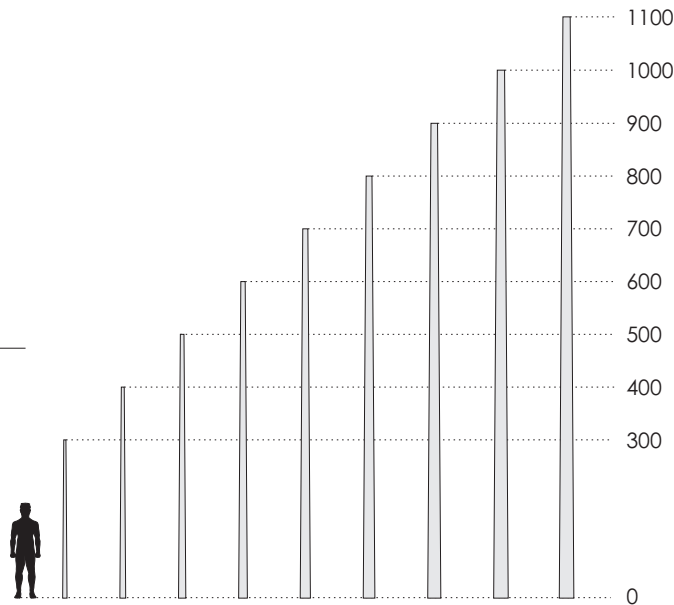

Flange plate mounted composite column heights available

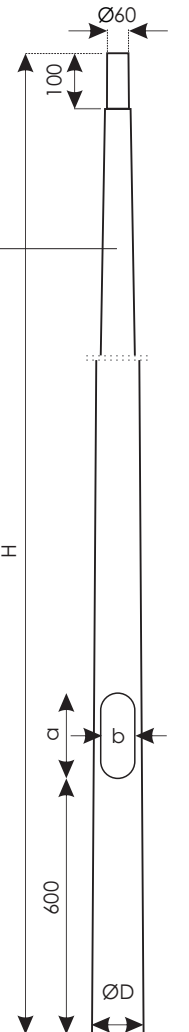

Flange plate mounted composite lighting column

Model	Height [m]	Base diameter [mm]	Top diameter [mm]	Base dimensions [mm]	Hole spacing [mm]	Foundation base	Weight [kg]
AGN-003	3	130	60	295x295	200x200	AF100/200	9.0
AGN-004	4	130	60	295x295	200x200	AF100/200	11.0
AGN-005	5	130	60	295x295	200x200	AF100/200	18.0
AGN-006	6	150	60	295x295	200x200	AF120/200	21.0
AGN-007	7	150	60	295x295	200x200	AF120/200	39.0
AGN-008	8	150	60	295x295	200x200	AF120/200	48.0
AGN-008	8	192	60	295x295	200x200	AF150/200	54.0
AGN-009	9	192	60	295x295	200x200	AF150/300	58.0
AGN-010	10	192	60	295x295	200x200	AF150/300	63.0
AGN-011	11	192	60	295x295	200x200	AF150/300	70.0



Root Mounted Composite

Lighting Column

The column is made of polyester glass laminate based on polyester resins and reinforced with fibreglass mat and fabric.

The structural fibres transmit compressive and tensile stresses, whereas the bonding substance transmits shearing forces, ensuring, as a connector, fibre-to-fibre mating. The weight content of fibres is not lower than 40%.

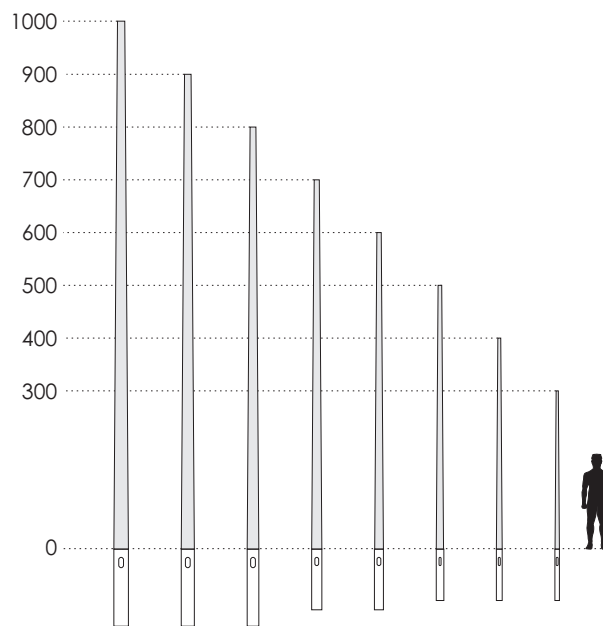
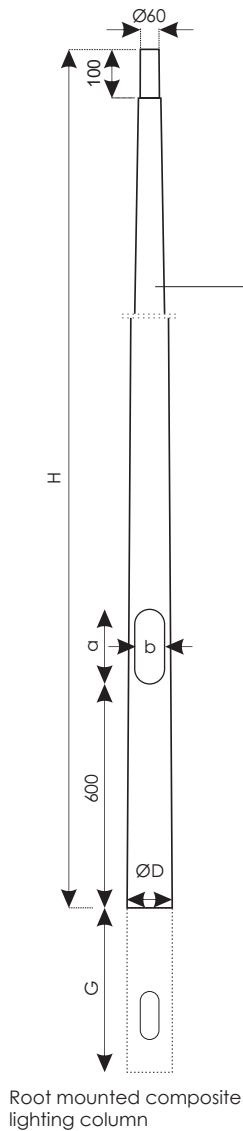

Model	Height [m]	Base diameter [mm]	Top diameter [mm]	Root length [mm]	Weight [kg]
AGW-003	3	130mm	60mm	1000	12.0
AGW-004	4	130mm	60mm	1000	14.0
AGW-005	5	130mm	60mm	1000	22.0
AGW-006	6	150mm	60mm	1200	25.0
AGW-007	7	150mm	60mm	1200	43.0
AGW-008	8	150mm	60mm	1200	51.0
AGW-008	8	192mm	60mm	1500	59.0
AGW-009	9	192mm	60mm	1500	63.0
AGW-010	10	192mm	60mm	1500	68.0

02

Precasts

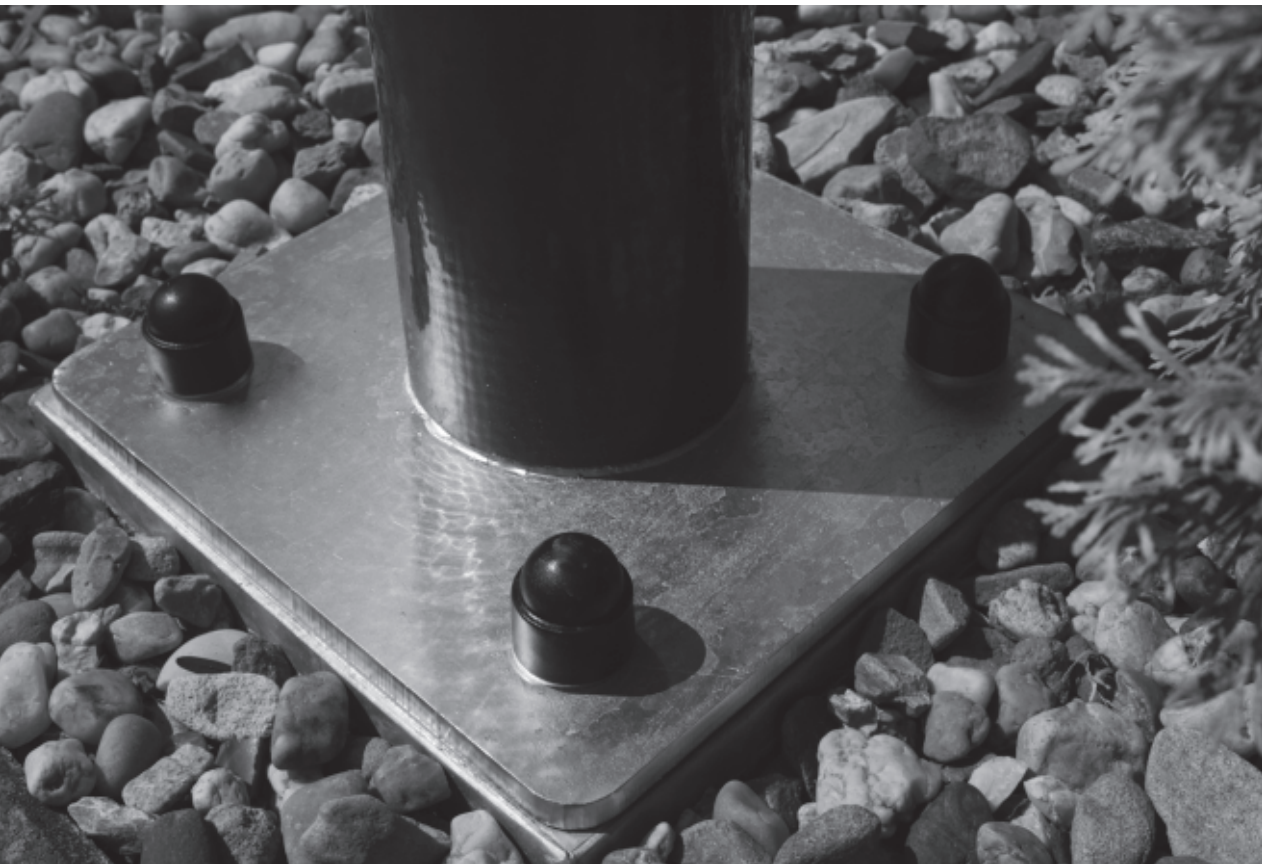

FOUNDATION BASE FOR COMPOSITE COLUMN MOUNTING

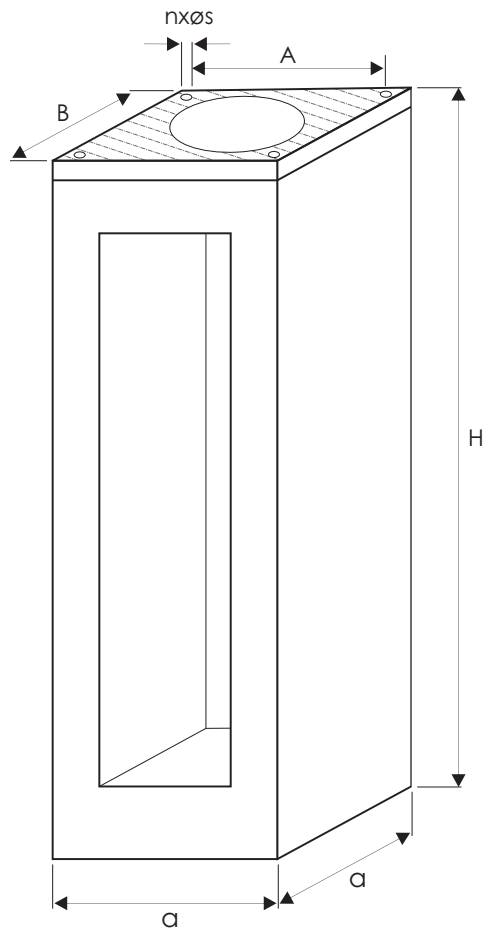

AxB - mounting hole spacing
 H - precast height
 a - precast base size
 n - quantity
 \varnothing - mounting screw diameter

PRODUCT DESCRIPTION

The foundation base is designed for mounting, using an AGN foot, composite lighting columns and other structures with a fixing moment of not more than M_g and the soil strength amounting to $G=390$ kN/m x m (as required under PN-EN 40).

ADVANTAGES

Monolithic (single piece) block made from concrete of strength class C 30/37 and exposure subclass XF3, with holes suitable for inserting electrical wiring. The reinforcement is made of grade AIIIIN steel. The concrete is compacted in the mould to obtain a uniform block in which column foot mounting nuts are embedded.

ACCESSORIES

M20x50 screw, M20x3 washer, M20 screw (grey) cover cap.

TYPE	H (mm)	a (mm)	AxB (mm)	nxø	m (kg)	M _g (kN/m)
AF-100/200	1000	300	200x200	4xM 20	140	3.9
AF-120/200	1200	300	200x200	4xM 20	160	9.3
AF-150/200	1500	300	200x200	4xM 20	200	25

03

Accessories





ALUMINIUM BRACKETS

FOR COMPOSITE COLUMNS

We offer various types of brackets and other accessories for mounting LED luminaires. **Colour and finish:** powder coated in RAL colours.

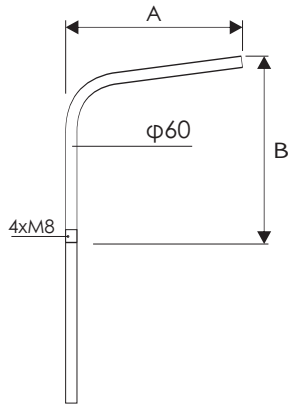

AGW1R-60

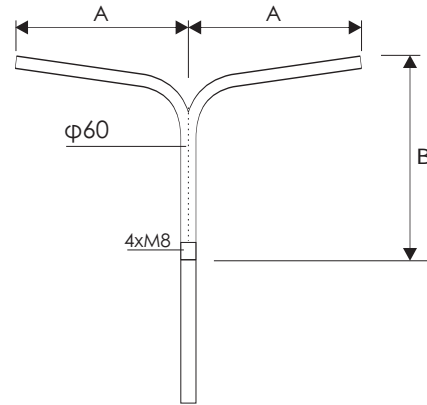

AGW2R-60

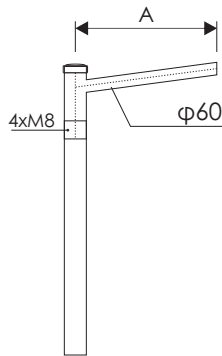

AGW1-60

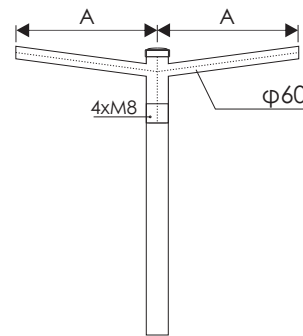

AGW2-60

TYP	A (mm)	B (mm)
AGW1R-60	500/1000/1500	500/1000
AGW2R-60	500/1000/1500	500/1000
AGW1-60	500/1000/1500	-
AGW2-60	500/1000/1500	-

A - bracket arm length, B- bracket arm height

Bracket tilt angle

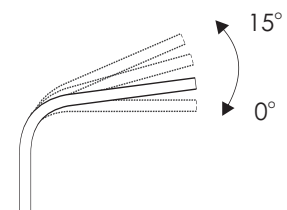

Upon customer request, brackets can be tilted at 0°, 5°, 10° or 15°.



04

Street lighting luminaires

Good quality street light luminaires mean safety and better visibility for motorists and pedestrians.

This is also more efficient traffic and accident prevention.







AG-ZHSL-03



MATERIAL:

high quality cast aluminium with anti-corrosion protection and UV resistant powder coating.

Available colours:

grey, black, silver

LIGHTING:

LED light source with various colour temperatures. In the standard version: natural white 3000/4000/6500K. Colour rendering index Ra>=70. Power factor PF>=0.95. LED lifespan: 50000h.

DESIGNED FOR:

streets, car parks, squares, parks, footpaths, etc.



AG-ZHSL-03-50

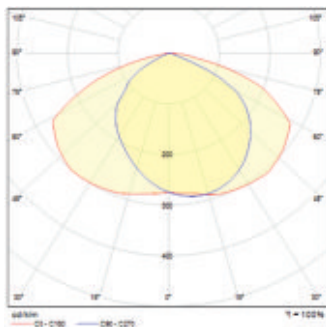

AG-ZHSL-03-100

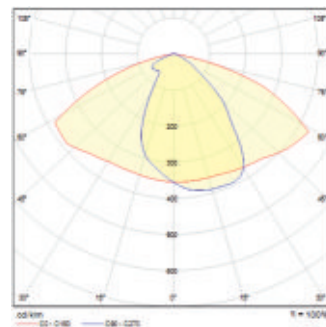

Model	Power	Luminous flux (+/- 5 %)	Input voltage	Frequency	Dimensions L/W/H [mm]	Weight [kg]
AG-ZHSL-03-50	50W	5250-6000lm	AC90-305V	50/60Hz	616.8/259.8/186.4	5.5
AG-ZHSL-03-100	100W	10500-12000lm	AC90-305V	50/60Hz	796.8/304.94/186.4	7.0

Installation tube diameter: Φ60mm. Mounting height AG-ZHSL-03-50: 6-8m, AG-ZHSL-03-100: 10-12m.



AG-ZHSL-06



MATERIAL:

high quality cast aluminium with anti-corrosion protection and UV resistant powder coating

Available colours:
grey, black, silver

LIGHTING:

LED light source with various colour temperatures. In the standard version: natural white 3000/4000/6500KD. Colour rendering index $Ra \geq 70$. Power factor $PF > 0.95$. LED lifespan: 50000h.

DESIGNED FOR:

streets, car parks, squares, parks, footpaths, etc.

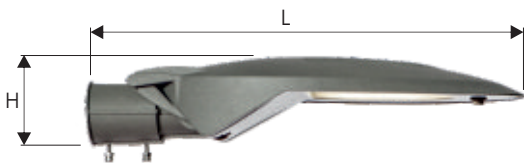

AG-ZHSL-06-40

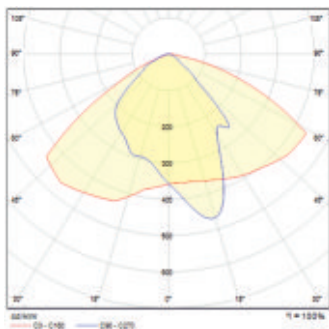

AG-ZHSL-06-80

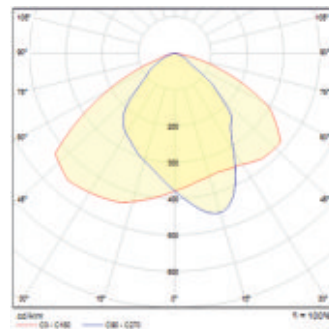

Model	Power	Luminous flux (+/- 5 %)	Input voltage	Frequency	Dimensions L/W/H [mm]	Weight [kg]
AG-ZHSL-06-40	40W	4200-4800lm	AC90-305V	50/60Hz	472.7/238.5/101.9	2.7
AG-ZHSL-06-80	80W	8400-9600lm	AC90-305V	50/60Hz	645.5/303.2/125.6	5.5

Installation tube diameter: $\Phi 50/60$ mm. Mounting height AG-ZHSL-06-40: 4-7m, AG-ZHSL-06-80: 8-10m.

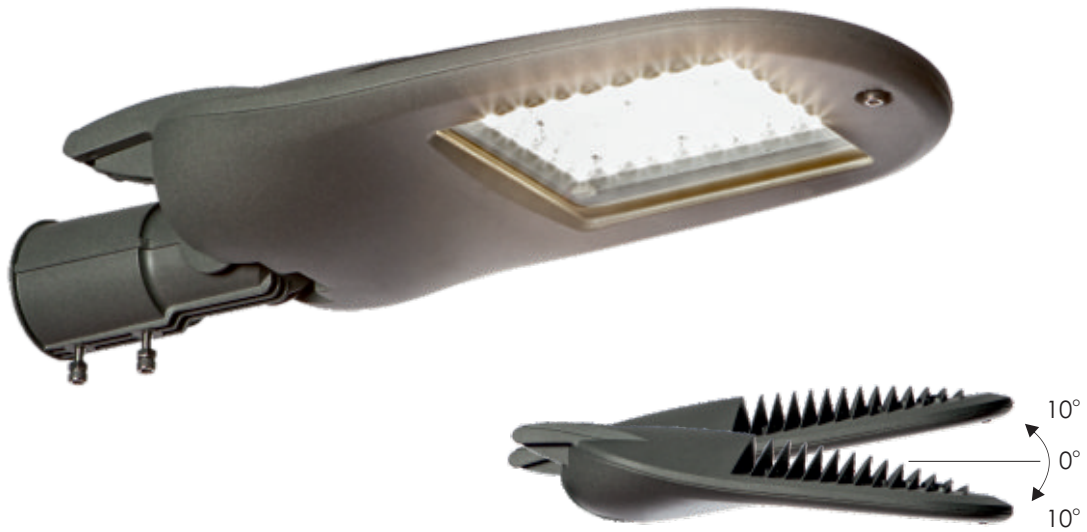

AG-ZHSL-09



MATERIAL:

high quality cast aluminium with anti-corrosion protection and UV resistant powder coating

Available colours:
 grey, black, silver

LIGHTING:

LED light source with various colour temperatures. In the standard version: natural white 3000/4000/6500K. Colour rendering index Ra>=70. Power factor PF>=0.95. LED lifespan: 50000h.

DESIGNED FOR:

streets, car parks, squares, parks, footpaths, etc.

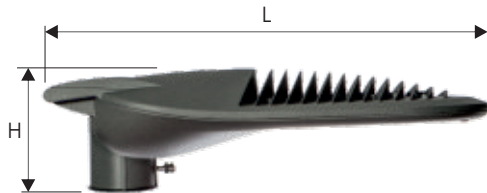

AG-ZHSL-09-50

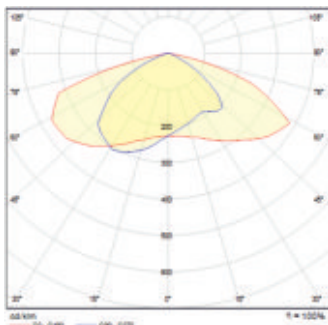

AG-ZHSL-09-100

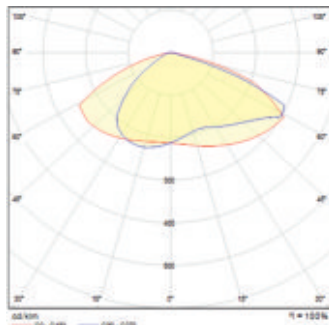

AG-ZHSL-09-150

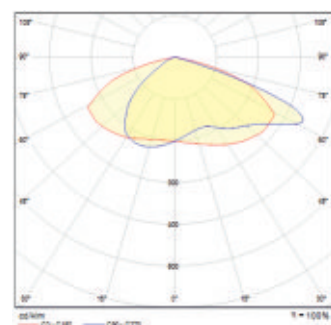

Model	Power	Luminous flux (+/- 5%)	Input voltage	Frequency	Dimensions L/W/H [mm]	Weight [kg]
AG-ZHSL-09-50	50W	6300-7200lm	AC90-305V	50/60Hz	485/230/98	3.62
AG-ZHSL-09-100	100W	10500-12000lm	AC90-305V	50/60Hz	622/292/112	6.2
AG-ZHSL-09-150	150W	15750-18000lm	AC90-305V	50/60Hz	846/367/134	12.2

Installation tube diameter: Φ50/Φ60mm, AG-ZHSL-09-150: Φ60/Φ70mm. Mounting height AG-ZHSL-09-50: 6-8m, AG-ZHSL-09-100: 8-10m, AG-ZHSL-09-150: 10-12m.



AG-ZHSL-11



MATERIAL:

high quality cast aluminium with anti-corrosion protection and UV resistant powder coating

Available colours:
grey, black, silver

LIGHTING:

LED light source with various colour temperatures. In the standard version: natural white 3000/4000/6500K. Colour rendering index $Ra \geq 70$. Power factor $PF \geq 0.95$. LED lifespan: 50000h.

DESIGNED FOR:

streets, car parks, squares, parks, footpaths, etc.

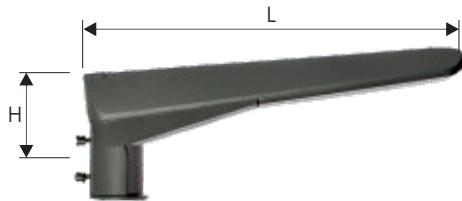

AG-ZHSL-11-40

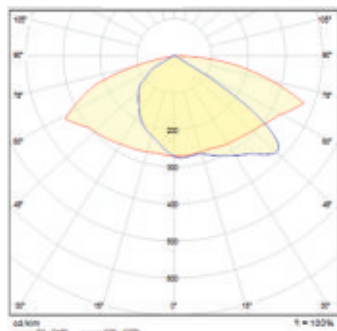

AG-ZHSL-11-50

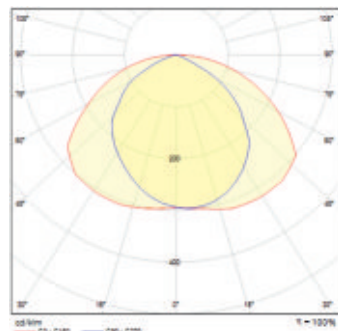

AG-ZHSL-11-120

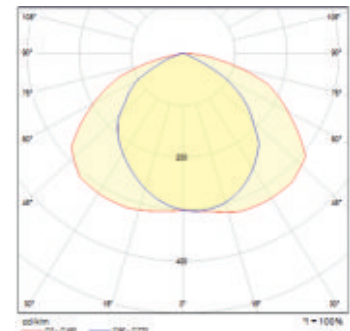

Model	Power	Luminous flux (+/- 5%)	Input voltage	Frequency	Dimensions L/W/H [mm]	Weight [kg]
AG-ZHSL-11-40	40W	4200-4800lm	AC90-305V	50/60Hz	519/220/117	2.8
AG-ZHSL-11-50	50W	6300-7200lm	AC90-305V	50/60Hz	590/256/131	4.66
AG-ZHSL-11-120	120W	10500-12000lm	AC90-305V	50/60Hz	738/320/164	8.6

Installation tube diameter: $\Phi 50/\Phi 60$ mm, AG-ZHSL-11-120: $\Phi 60$ mm. Mounting height AG-ZHSL-11-40: 4-7m, AG-ZHSL-11-50: 6-8m, AG-ZHSL-11-120: 8-10m.



AG-ZHSL-13



MATERIAL:

high quality cast aluminium with anti-corrosion protection and UV resistant powder coating

Available colours:
 grey, black, silver

LIGHTING:

LED light source with various colour temperatures. In the standard version: natural white 3000/4000/6500K. Colour rendering index Ra>=70. Power factor PF>=0.95. LED lifespan: 50000h.

DESIGNED FOR:

streets, car parks, squares, parks, footpaths, etc.

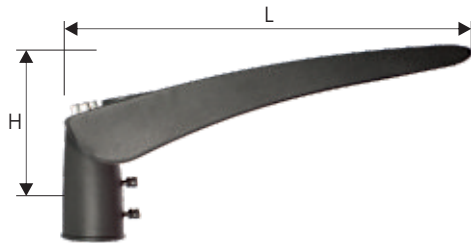

AG-ZHSL-13-50

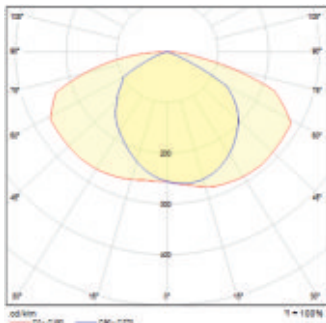

AG-ZHSL-13-100

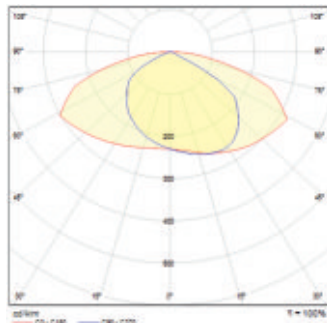

AG-ZHSL-13-150

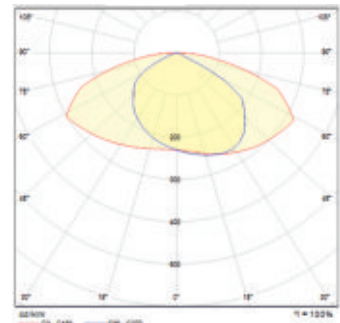

Model	Power	Luminous flux (+/- 5%)	Input voltage	Frequency	Dimensions L/W/H [mm]	Weight [kg]
AG-ZHSL-13-50	50W	5240-6000lm	AC90-305V	50/60Hz	641/241/114	3.9
AG-ZHSL-13-100	100W	10500-12000lm	AC90-305V	50/60Hz	735/289/116	5.4
AG-ZHSL-13-150	150W	12600-14400lm	AC90-305V	50/60Hz	922/360/144	9.8

Installation tube diameter: Φ60mm, AG-ZHSL-13-150: Φ70mm. Mounting height AG-ZHSL-13-50: 6-8m, AG-ZHSL-13-100: 8-10m, AG-ZHSL-13-150: 10-12m.

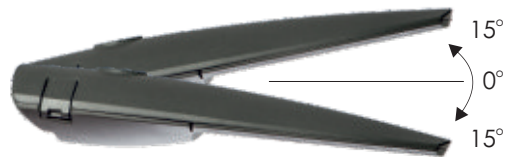

AG-ZHSL-14



MATERIAL:

high quality cast aluminium with anti-corrosion protection and UV resistant powder coating

Available colours:
grey, black, silver

LIGHTING:

LED light source with various colour temperatures. In the standard version: natural white 3000/4000/6500K. Colour rendering index Ra>=70. Power factor PF>=0.95. LED lifespan: 50000h.

DESIGNED FOR:

streets, car parks, squares, parks, footpaths, etc.



AG-ZHSL-14-50

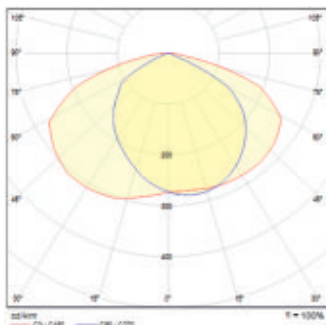

AG-ZHSL-14-120

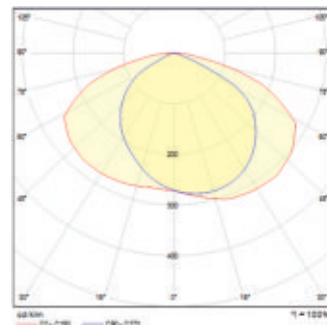

Model	Power	Luminous flux (+/- 5 %)	Input voltage	Frequency	Dimensions L/W/H [mm]	Weight [kg]
AG-ZHSL-14-50	50W	6300-7200lm	AC90-305V	50/60Hz	738/289/118	5.2
AG-ZHSL-14-120	120W	12600-14400lm	AC90-305V	50/60Hz	922/362/140	8.2

Installation tube diameter: Φ60mm. Mounting height AG-ZHSL-14-50: 6-8m, AG-ZHSL-14-120: 10-12m.



AG-LS



MATERIAL:
 high quality cast aluminium with anti-corrosion protection and UV resistant powder coating

Available colours:
 grey, black

LIGHTING:
 LED light source with various colour temperatures. In the standard version: natural white 3000/4000/5000/5700K. Colour rendering index Ra>=80. Power factor PF>=0.95. LED lifespan: 50000h. Input voltage:100-240/277V AC.

DESIGNED FOR:
 streets, car parks, squares, parks, footpaths, etc.

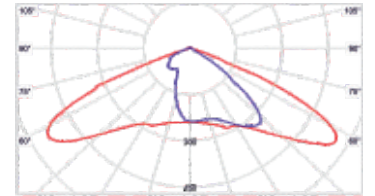
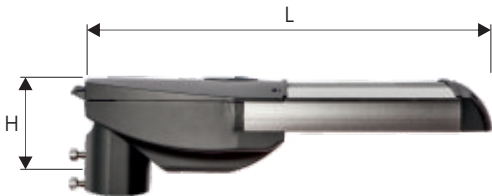

cd/klm — C90-C270 — C0-C180 $\eta=100\%$

Model	Power	Luminous flux (+/- 5 %)	Mounting height	Frequency	Dimensions L/W/H [mm]	Weight [kg]
AG-LS1B-30	30W	3942lm	4-7m	50/60Hz	431/316/136	5.3
AG-LS1B-50	50W	6570lm	5-8m	50/60Hz	431/316/136	5.3
AG-LS2B-60	60W	8117lm	6-10m	50/60Hz	504/316/136	6.1
AG-LS2B-80	80W	10057lm	7-11m	50/60Hz	504/316/136	6.1
AG-LS2B-100	100W	11525lm	8-12m	50/60Hz	504/316/136	6.1
AG-LS3B-120	120W	13830lm	9-14m	50/60Hz	577/316/136	7.3
AG-LS3B-150	150W	17305lm	10-15m	50/60Hz	577/316/136	7.3
AG-LS4B-180	180W	20884lm	11-16m	50/60Hz	650/316/136	8.2
AG-LS4B-200	200W	23205lm	11-17m	50/60Hz	650/316/136	8.2
AG-LS5B-240	240W	29006lm	12-18m	50/60Hz	723/316/136	9.0
AG-LS5B-300	300W	34800lm	14-20m	50/60Hz	796/316/136	9.9
AG-LS5B-350	350W	40600lm	15-21m	50/60Hz	869/316/136	10.8



AG-LUG-U



MATERIAL:
high quality cast aluminium with anti-corrosion protection and UV resistant powder coating

Available colours:
grey, graphite

LIGHTING:
LED light source with various colour temperatures. In the standard version: natural white 4000/5000/5700K. Colour rendering index $Ra \geq 70$. Power factor $PF \geq 0.95$. LED lifespan: 50000h.

DESIGNED FOR:
streets, car parks, squares, parks, footpaths, etc.

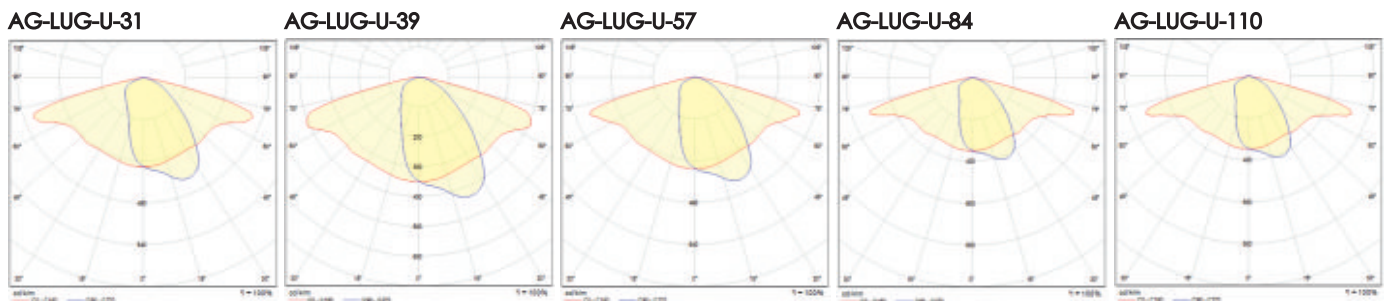
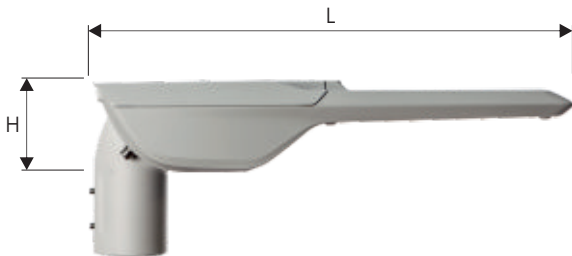

Model	Power	Luminous flux (+/- 5 %)	Mounting height	Frequency	Dimensions L/W/H [mm]	Weight [kg]
AG-LUG-U-31	31W	3942lm	4-6m	50/60Hz	550/250/100	6.8
AG-LUG-U-39	39W	6570lm	5-7m	50/60Hz	550/250/100	6.8
AG-LUG-U-57	57W	8117lm	6-8m	50/60Hz	550/250/100	6.8
AG-LUG-U-84	84W	10057lm	7-9m	50/60Hz	550/250/100	6.8
AG-LUG-U-110	110W	11525lm	8-10m	50/60Hz	550/250/100	6.8



AG-ZHSL-12A



MATERIAL:

high quality cast aluminium with anti-corrosion protection and UV resistant powder coating

Available colours:
 grey, black, silver

LIGHTING:

LED light source with various colour temperatures. In the standard version: natural white 3000/4000/6500K. Colour rendering index Ra>=70. Power factor PF>=0.95. LED lifespan: 50000h.

DESIGNED FOR:

streets, car parks, squares, parks, footpaths, etc.

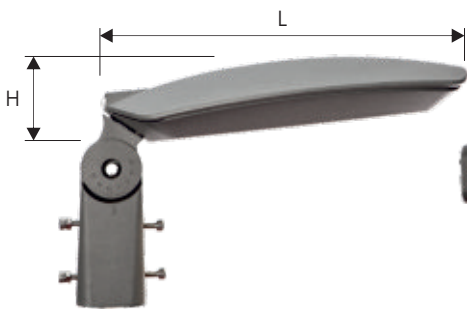

AG-ZHSL-12A-50-AG-ZHSL-12A-150

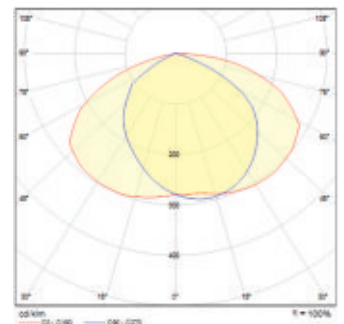

Model	Power	Luminous flux (+/- 5 %)	Mounting height	Frequency	Dimensions L/W/H [mm]	Weight [kg]
AG-ZHSL-12A-50	50W	8400-9600lm	4-7m	50/60Hz	603/416/132	6.2
AG-ZHSL-12A-60	60W	8400-9600lm	5-8m	50/60Hz	603/416/132	6.2
AG-ZHSL-12A-70	70W	8400-9600lm	6-9m	50/60Hz	603/416/132	6.2
AG-ZHSL-12A-80	80W	8400-9600lm	7-10m	50/60Hz	603/416/132	6.2
AG-ZHSL-12A-100	100W	12600-15750lm	8-11m	50/60Hz	580/522/390	9.8
AG-ZHSL-12A-120	120W	12600-15750lm	9-12m	50/60Hz	580/522/390	9.8
AG-ZHSL-12A-150	150W	12600-15750lm	10-13m	50/60Hz	580/522/390	9.8

05

Floodlights

Compared with conventional halogen floodlights, LED floodlights mean above average energy savings and durability .

Due to their solid housing and reliable power system, they are unrivalled when it comes to industrial and private applications.





Floodlight



MATERIAL:
 high quality cast aluminium with anti-corrosion protection and UV resistant powder coating

Available colours:
 grey

LIGHTING:
 LED light source with various colour temperatures. In the standard version: natural white 4000/5700K. Colour rendering index $Ra \geq 70$. Power factor $PF \geq 0.95$. LED lifespan: 100000h.

DESIGNED FOR: industrial facilities, warehouses, underground, car parks, façades, sports fields, halls, etc.

AG-N-25

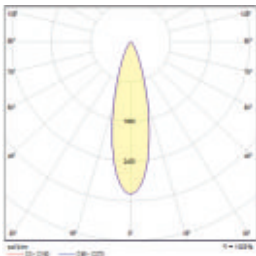

AG-N-45

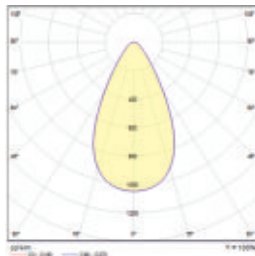

AG-N-54

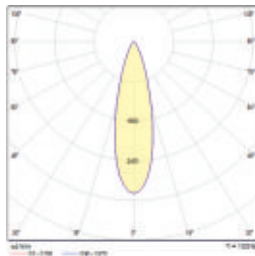

AG-N-70

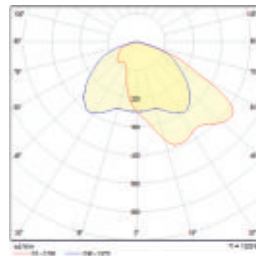

AG-N-150

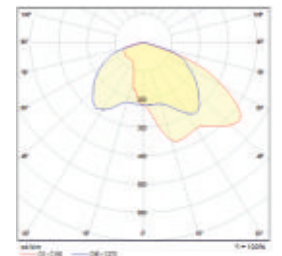

Model	Power	Luminous flux (+/- 5 %)	Frequency	Dimensions L/W/H [mm]	Weight [kg]
AG-N-25	25W	3300lm	50/60Hz	272/238/73	3.5
AG-N-45	45W	5500lm	50/60Hz	272/238/73	3.7
AG-N-54	54W	6450lm	50/60Hz	272/238/73	3.75
AG-N-70	70W	7400lm	50/60Hz	272/238/73	3.85
AG-N-150	150W	16700lm	50/60Hz	403/405/95	8.8



06

Modern Luminaires

Modern lighting columns represent a crucial architectural element of city buildings, parks and squares. They merge into the space, becoming its indispensable feature.

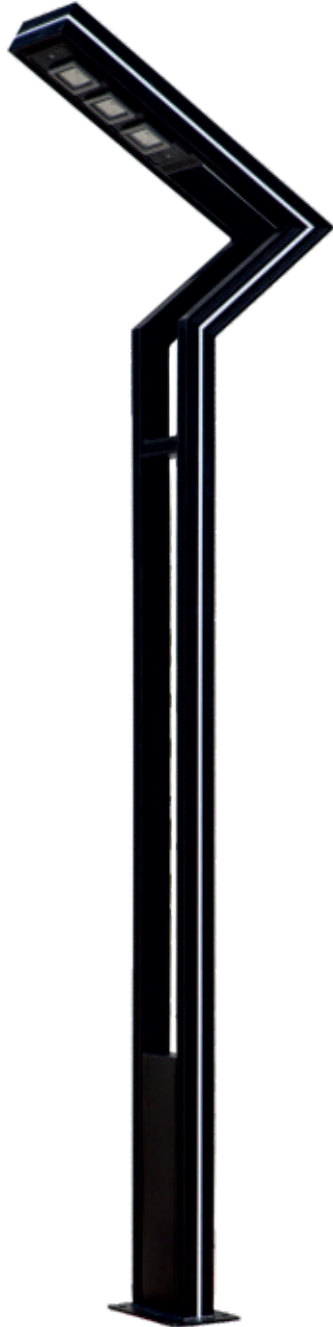

AG-GN-003

**MATERIAL:**

high quality cast aluminium 6063 with anti-corrosion protection and UV resistant powder coating

Available colours:

matte graphite

LIGHTING:

LED light source with various colour temperatures. In the standard version: natural white 4000K.
 Colour rendering index $R_a \geq 70$.
 Power factor $PF \geq 0.95$.
 LED lifespan: 50000h.

LED strip:

neutral, blue, red, green.

DESIGNED FOR:

streets, car parks,
 squares, parks,
 footpaths, etc.

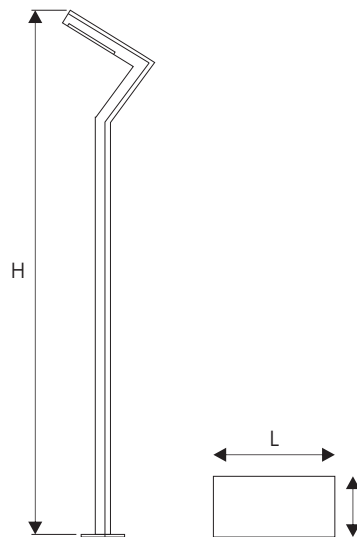

Model	Power	Distribution angle	Input voltage	Frequency	Dimensions L/W/H [mm]	Weight [kg]
AG-GN-003	30W+20W	90°x140°	AC85V-265V	50/60Hz	80/40/3000	15.0

AG-GN-004



MATERIAL:

high quality cast aluminium 6063 with anti-corrosion protection and UV resistant powder coating

Available colours:

matte graphite

LIGHTING:

LED light source with various colour temperatures. In the standard version: natural white 4000K.
 Colour rendering index Ra>=70. Power factor PF>=0.95.
 LED lifespan: 50000h.

LED strip:

neutral, blue, red, green.

DESIGNED FOR:

streets, car parks, squares, parks, footpaths, etc.

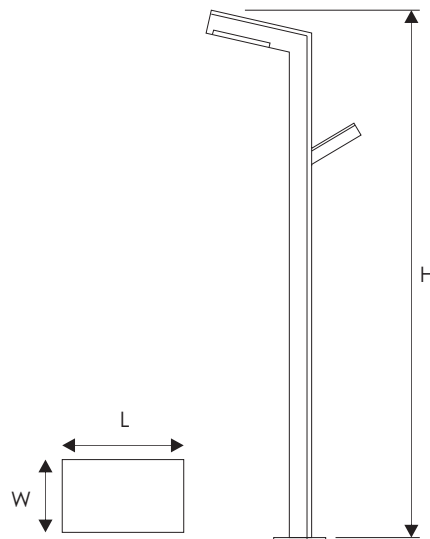

Model	Power	Distribution angle	Input voltage	Frequency	Dimensions L/W/H [mm]	Weight [kg]
AG-GN-004	30W+20W+28W	90°x140°	AC85V-265V	50/60Hz	130/85/3000	15.5

AG-GN-008

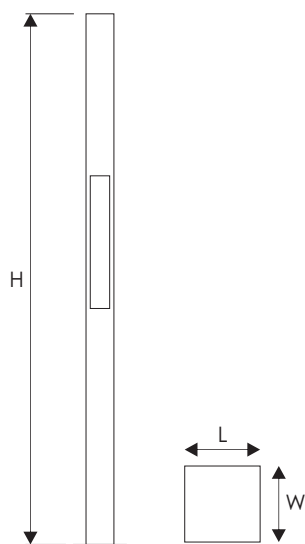
**MATERIAL:**

high quality cast aluminium 6063 with anti-corrosion protection and UV resistant powder coating

Available colours:

matte graphite

LIGHTING:

LED light source with various colour temperatures. In the standard version: natural white 4000K.

Colour rendering index $Ra \geq 70$. Power factor $PF \geq 0.95$.

LED lifespan: 50000h.

LED strip:

neutral, blue, red, green.

DESIGNED FOR:

streets, car parks, squares, parks, footpaths, etc.

Model	Power	Distribution angle	Input voltage	Frequency	Dimensions L/W/H [mm]	Weight [kg]
AG-GN-008	20W+20W	90°x140°	AC85V-265V	50/60Hz	200/200/3500	34.5

AG-DHL-17821



MATERIAL:

steel and high quality cast aluminium with anti-corrosion protection and UV resistant powder coating

Available colours:

matte black

LIGHTING:

LED light source with various colour temperatures. In the standard version: natural white 4000K, 5700K. Colour rendering index $Ra \geq 70$. Power factor $PF \geq 0.95$. LED lifespan: 50000h.

SHADE:

optical lens

DESIGNED FOR:

streets, car parks, squares, parks, footpaths, etc.

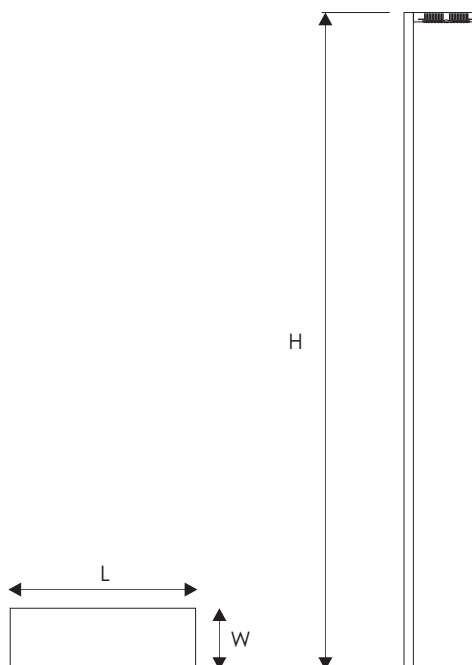

Model	Power	Distribution angle	Input voltage	Frequency	Dimensions L/W/H [mm]	Weight [kg]
AG-DHL-17821-50	50W	90°x140°	AC90-260V	50/60Hz	150/50/3500	15.2

AG-DHL-17824

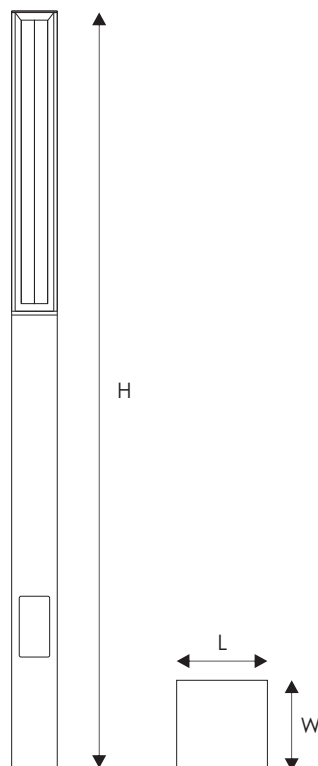
**MATERIAL:**

high quality cast aluminium with anti-corrosion protection and UV resistant powder coating

Available colours:

matte black

LIGHTING:

LED light source with various colour temperatures. In the standard version: natural white 4000K, 5700K.

Colour rendering index $R_a \geq 70$.

Power factor $PF \geq 0.95$.

LED lifespan: 50000h.

SHADE:

Opal PMMA

DESIGNED FOR:

streets, car parks, squares, parks, footpaths, etc.

Model	Power	Distribution angle	Input voltage	Frequency	Dimensions L/W/H [mm]	Weight [kg]
AG-DHL-17824	20W	90°x140°	AC90-305V	50/60Hz	120/120/2000	5.5

AG-DHL-17825



MATERIAL:

high quality cast aluminium with anti-corrosion protection and UV resistant powder coating

Available colours:

matte black

LIGHTING:

LED light source with various colour temperatures. In the standard version: natural white 4000K, 5700K. Colour rendering index $R_a \geq 70$. Power factor $PF \geq 0.95$. LED lifespan: 50000h.

SHADE:

PMMA

DESIGNED FOR:

streets, car parks, squares, parks, footpaths, etc.

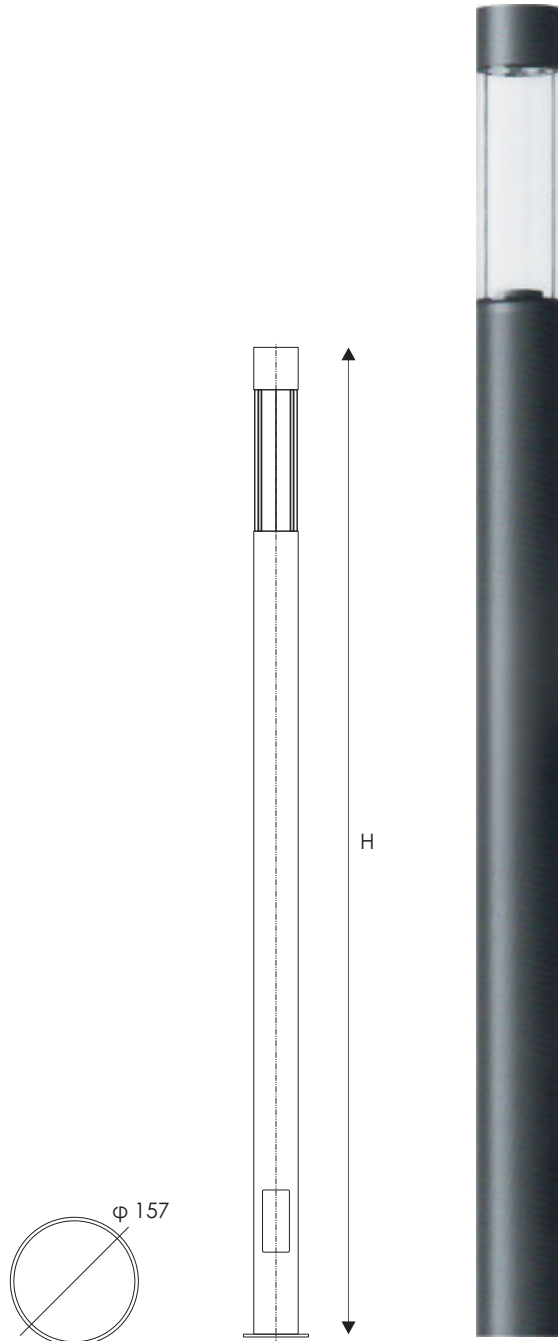

Model	Power	Distribution angle	Input voltage	Frequency	Dimensions L/W/H [mm]	Weight [kg]
AG-DHL-17825	20W	90°x140°	AC90-305V	50/60Hz	157/157/3500	7.0

AG-DHL-17826

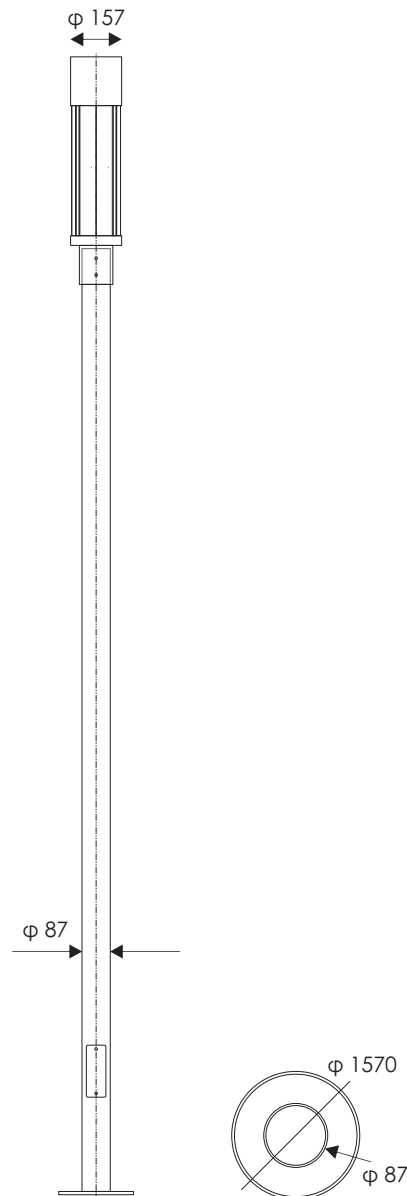
**MATERIAL:**

high quality cast aluminium with anti-corrosion protection and UV resistant powder coating

Available colours:

matte black

LIGHTING:

LED light source with various colour temperatures. In the standard version: natural white 4000K, 5700K. Colour rendering index $R_a \geq 70$. Power factor $PF \geq 0.95$. LED lifespan: 50000h.

SHADE:

transparent PMMA

DESIGNED FOR:

streets, car parks, squares, parks, footpaths, etc.

Model	Power	Distribution angle	Input voltage	Frequency	Dimensions L/W/H [mm]	Weight [kg]
AG-DHL-17826	20W	90°x140°	AC90-305V	50/60Hz	87/87/3500	7.0

AG-DHL-17827



MATERIAL:

high quality cast aluminium with anti-corrosion protection and UV resistant powder coating

Available colours:

matte black

LIGHTING:

LED light source with various colour temperatures. In the standard version: natural white 4000K, 5700K. Colour rendering index $R_a \geq 70$. Power factor $PF \geq 0.95$. LED lifespan: 50000h.

SHADE:

transparent PMMA

DESIGNED FOR:

streets, car parks, squares, parks, footpaths, etc.

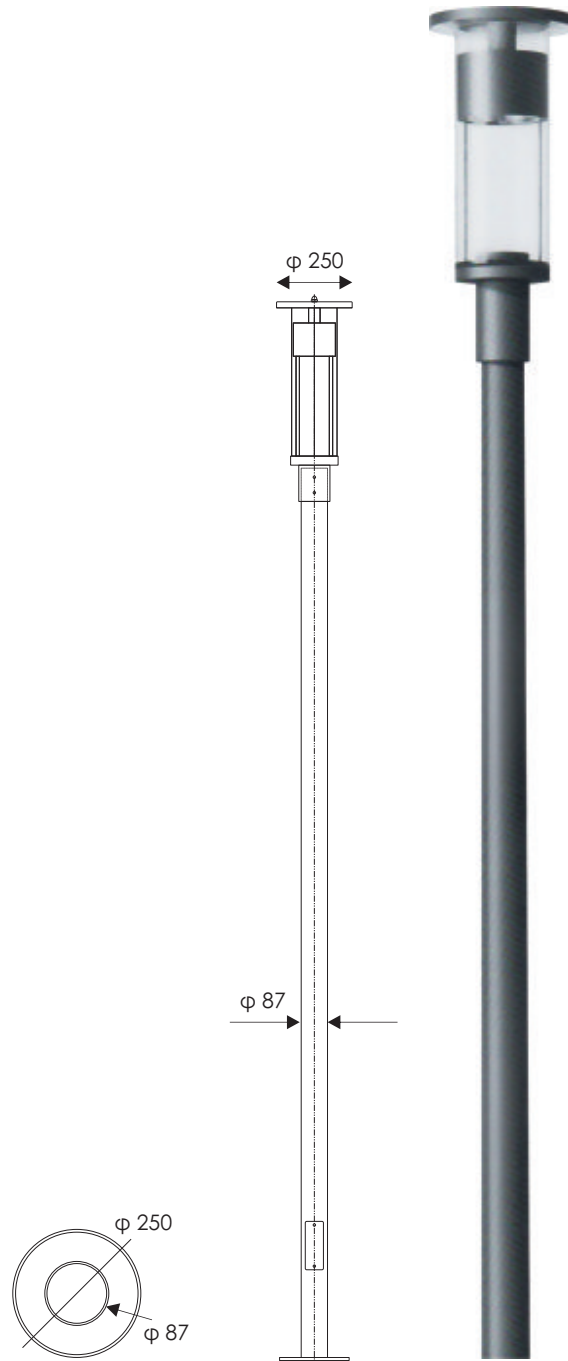

Model	Power	Distribution angle	Input voltage	Frequency	Dimensions L/W/H [mm]	Weight [kg]
AG-DHL-17827	20W	90°x140°	AC90-305V	50/60Hz	87/87/3500	7.0



07

Garden & Park Luminaires

The beauty of a park or garden can be relished not only during the day, but also at dusk.

To enjoy an awesome evening atmosphere, you need only to select the right columns and luminaires and arrange them properly among the greens.

The lighting we offer will create a unique climate, illuminating alleys, showing the way and highlighting your landscape architecture.





AG-TYD-6116



MATERIAL:

The housing is made of die-cast aluminium, with the surface being electrostatically powder coated.

The light cover is made of robust high-end tempered glass.

The reflector is made of high grade aluminium.

The body is sealed with silicone.

Available colours:
 grey

LIGHTING:

LED light source with various colour temperatures. In the standard version: natural white 3000-6500K. Colour rendering index Ra>=70. Power factor PF>=0.95. LED lifespan: 50000h.

DESIGNED FOR:

parks, gardens, cycleways, alleys, pavements, housing developments, public spaces, playgrounds, promenades, access roads, etc.

AG-TYD-1016-20

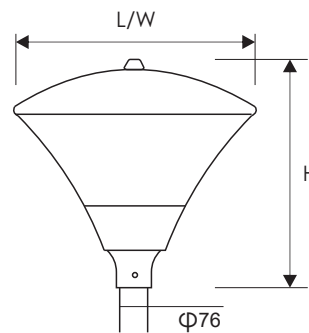
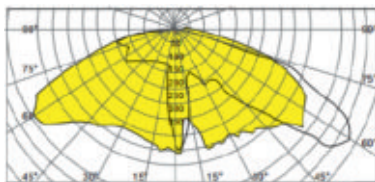

Model	Power	Luminous flux (+/- 5 %)	Input voltage	Frequency	Dimensions L/W/H [mm]	Weight [kg]
AG-TYD-1016-20	20W	1744lm	AC120-277V	50/60Hz	593/593/523	6.6
AG-TYD-1016-30	30W	2520lm	AC120-277V	50/60Hz	593/593/523	6.6

Luminaire to be installed directly on the column with top diameter $\phi 76$ mm. Installation height from 3-4m



AG-LUG-P



MATERIAL:

The housing is made of die-cast aluminium, with the surface being electrostatically powder coated.

The light cover is made of polycarbonate.

The body is sealed with silicone.

Available colours:
 grey

LIGHTING:

LED light source with various colour temperatures. In the standard version: natural white 3000-6500K. Colour rendering index $R_a \geq 70$. Power factor $PF \geq 0.95$. LED lifespan: 100000h.

Available upon request:
 DALI, NTC

DESIGNED FOR:

parks, gardens, cycleways, alleys, pavements, housing developments, public spaces, playgrounds, promenades, access roads, etc.

AG-LUG-P-20

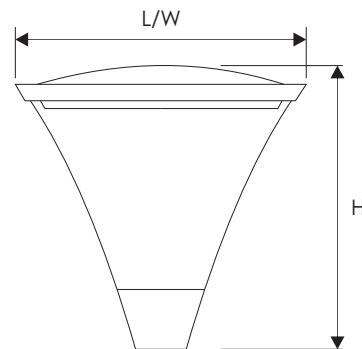
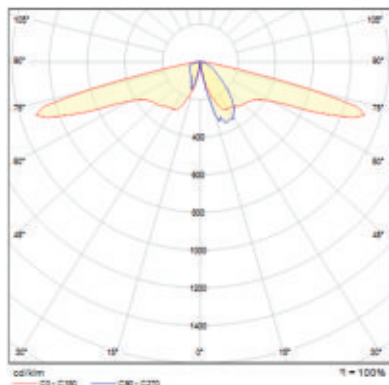

Model	Power	Luminous flux (+/- 5 %)	Input voltage	Frequency	Dimensions L/W/H [mm]	Weight [kg]
AG-LUG-P-14	14W	1650-1800lm	220-240V	50/60Hz	570x570x560	6.2
AG-LUG-P-20	20W	2300-2500lm	220-240V	50/60Hz	570x570x560	6.2
AG-LUG-P-28	28W	3050-3300lm	220-240V	50/60Hz	570x570x560	6.2
AG-LUG-P-42	42W	4150-4600lm	220-240V	50/60Hz	570x570x560	6.2

Luminaire to be installed directly on the column with top diameter $\phi 60$ mm. Installation height from 3-4m



AG-TYD-1016



MATERIAL:

The housing is made of die-cast aluminium, with the surface being electrostatically powder coated.

The light cover is made of robust high-end tempered glass.

The reflector is made of high grade aluminium.

The body is sealed with silicone.

Available colours:
grey

LIGHTING:

LED light source with various colour temperatures. In the standard version: natural white 3000-6500K. Colour rendering index $Ra \geq 70$. Power factor $PF \geq 0.95$. LED lifespan: 50000h.

DESIGNED FOR:

parks, gardens, cycleways, alleys, pavements, housing developments, public spaces, playgrounds, promenades, access roads, etc.

AG-TYD-1016-50

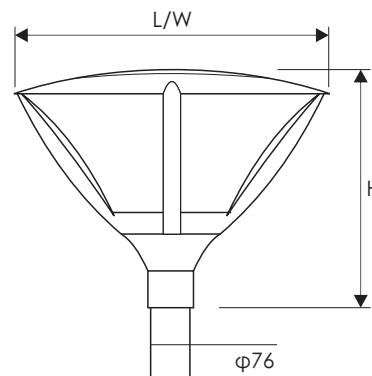
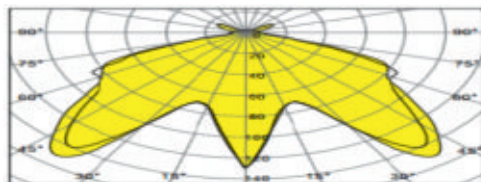

Model	Power	Luminous flux (+/- 5 %)	Input voltage	Frequency	Dimensions L/W/H [mm]	Weight [kg]
AG-TYD-1016-35	35W	3290lm	120-277V	50/60Hz	690x690x480	9.5
AG-TYD-1016-50	50W	4890lm	120-277V	50/60Hz	690x690x480	9.5
AG-TYD-1016-60	60W	5408lm	120-277V	50/60Hz	690x690x480	9.5

Luminaire to be installed directly on the column with top diameter $\phi 76$ mm. Installation height from 3-4m



AG-TYD-2016



MATERIAL:

The housing is made of die-cast aluminium, with the surface being electrostatically powder coated.

The reflector is made of high grade aluminium.

The body is sealed with silicone.

Available colours:
 grey

LIGHTING:

LED light source with various colour temperatures. In the standard version: natural white 3000-6500K. Colour rendering index $Ra \geq 75$. Power factor $PF \geq 0.95$. LED lifespan: 50000h.

DESIGNED FOR:

parks, gardens, cycleways, alleys, pavements, housing developments, public spaces, playgrounds, promenades, access roads, etc.

AG-TYD-2016-50

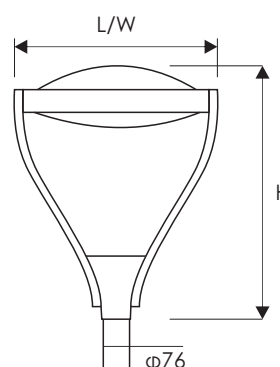
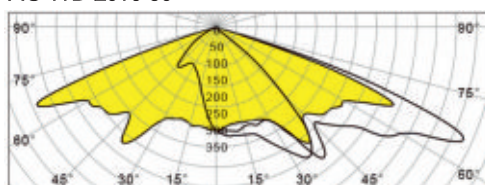

Model	Power	Luminous flux (+/- 5 %)	Input voltage	Frequency	Dimensions L/W/H [mm]	Weight [kg]
AG-TYD-2016-35	35W	3290lm	120-277V	50/60Hz	620x620x800	11.5
AG-TYD-2016-50	50W	4890lm	120-277V	50/60Hz	620x620x800	11.5
AG-TYD-2016-60	60W	5408lm	120-277V	50/60Hz	620x620x800	11.5

Luminaire to be installed directly on the column with top diameter $\phi 76$ mm. Installation height from 3-4m



AG-DHL-16069



MATERIAL:

The housing is made of die-cast aluminium, with the surface being electrostatically powder coated.

The reflector is made of high grade aluminium.

The body is sealed with silicone.

Available colours:
matte black

LIGHTING:

LED light source with various colour temperatures. In the standard version: natural white 3000-6500K. Colour rendering index $Ra \geq 70$. Power factor $PF \geq 0.95$. LED lifespan: 50000h.

DESIGNED FOR:

parks, gardens, cycleways, alleys, pavements, housing developments, public spaces, playgrounds, promenades, access roads, etc.

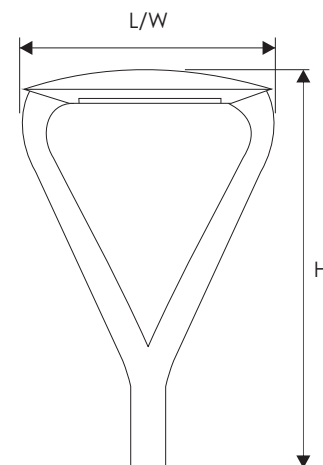
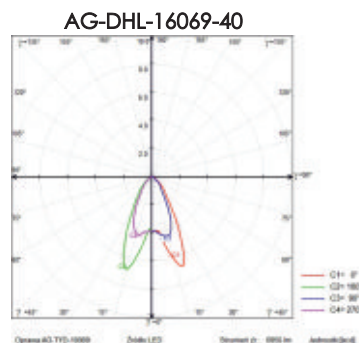

Model	Power	Luminous flux (+/- 5 %)	Input voltage	Frequency	Dimensions L/W/H [mm]	Weight [kg]
AG-DHL-16069-20	20W, 30W	2100-3200lm	220-240V	50/60Hz	520x520x700	12.0
AG-DHL-16069-40	40W, 50W	4200-5150lm	220-240V	50/60Hz	520x520x700	12.0
AG-DHL-16069-60	60W, 70W	6200-7120lm	220-240V	50/60Hz	520x520x700	12.0
AG-DHL-16069-80	80W	8150lm	220-240V	50/60Hz	520x520x700	12.0

Luminaire to be installed directly on the column with top diameter $\phi 76$ mm. Installation height from 3-4m



AG-TYD-5116



MATERIAL:

The housing is made of die-cast aluminium, with the surface being electrostatically powder coated.

The reflector is made of high grade aluminium.

The body is sealed with silicone.

Available colours:
 grey

LIGHTING:

LED light source with various colour temperatures. In the standard version: natural white 3000-6500K. Colour rendering index $Ra \geq 70$. Power factor $PF \geq 0.95$. LED lifespan: 50000h.

DESIGNED FOR:

parks, gardens, cycleways, alleys, pavements, housing developments, public spaces, playgrounds, promenades, access roads, etc.

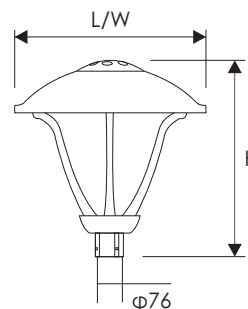
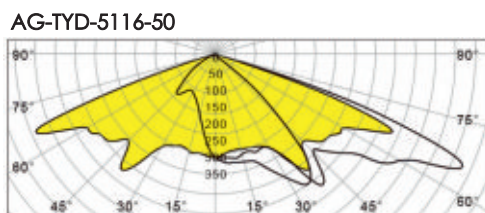

Model	Power	Luminous flux (+/- 5 %)	Input voltage	Frequency	Dimensions L/W/H [mm]	Weight [kg]
AG-TYD-5116-35	35W	3290lm	120-277V	50/60Hz	650x650x674	10.4
AG-TYD-5116-50	50W	4890lm	120-277V	50/60Hz	650x650x674	10.4
AG-TYD-5116-60	60W	5408lm	120-277V	50/60Hz	650x650x674	10.4

Luminaire to be installed directly on the column with top diameter $\phi 76$ mm. Installation height from 3-4m



08

Heritage Luminaires



AG-16264



COLUMN: high-end die-cast aluminium alloy with anti-corrosion protection and UV resistant powder coating

FINISH: matte black in the standard version

CONNECTOR: made of hot-dip galvanised, surface protected against corrosion

SHADE: opal plastic

LUMINAIRE: 45-85W LED bulb x 1, E27

DESIGNED FOR: streets, car parks, squares, parks, footpaths, etc.



AG-16264

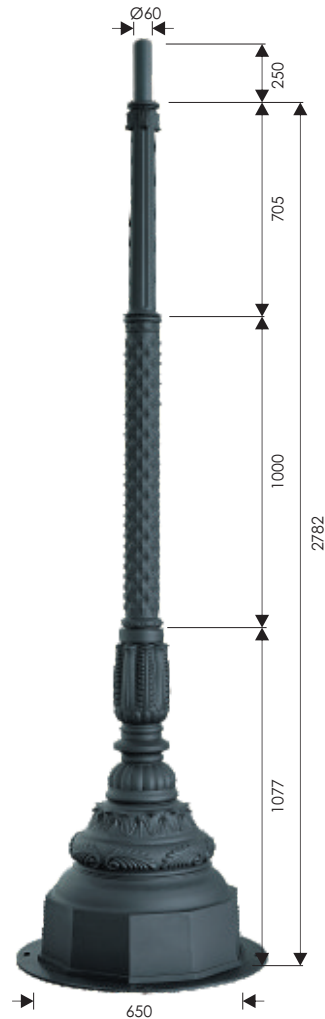
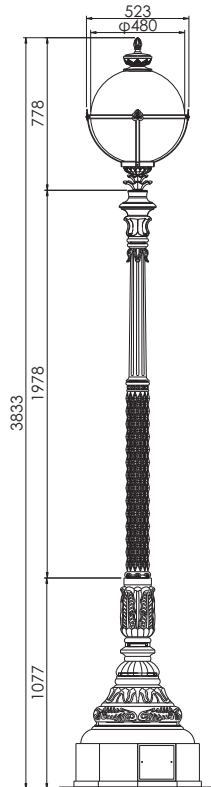

AG-16263

*depending on the model, available upon request in addition to the standard colour: matte black/matte grey/dark grey/dark brown/matte coffee and other RAL colours.

AG-14256



COLUMN: high-end die-cast aluminium alloy with anti-corrosion protection and UV resistant powder coating

CONNECTOR: made of hot-dip galvanised, surface protected against corrosion

LUMINAIRE:
 45-85W LED bulb x 1, E27

SHADE: opal plastic

FINISH:
 matte black in the standard version

DESIGNED FOR:
 streets, car parks, squares, parks, footpaths, etc.

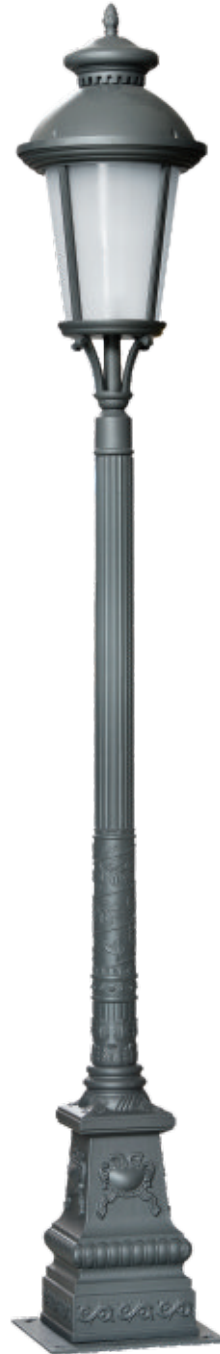
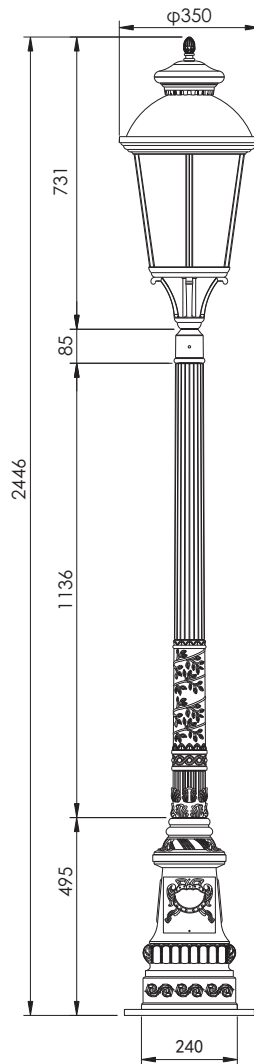

AG-14256

*depending on the model, available upon request in addition to the standard colour: matte black/matte grey/dark grey/dark brown/matte coffee and other RAL colours.

AG-16300



COLUMN: high-end die-cast aluminium alloy with anti-corrosion protection and UV resistant powder coating

FINISH: matte black in the standard version

CONNECTOR: made of hot-dip galvanised, surface protected against corrosion

SHADE: matte polycarbonate

REFLECTOR: anodised aluminium

LUMINAIRE: 45-85W LED bulb x 1, E27

DESIGNED FOR: streets, car parks, squares, parks, footpaths, etc.

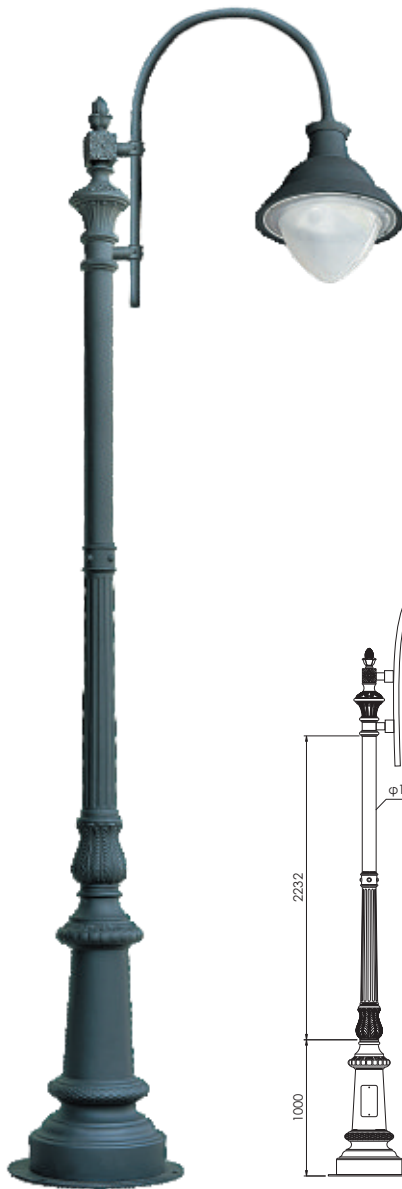

AG-16300

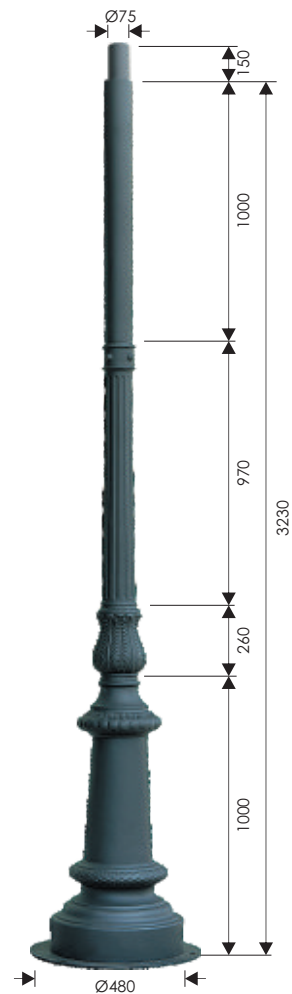
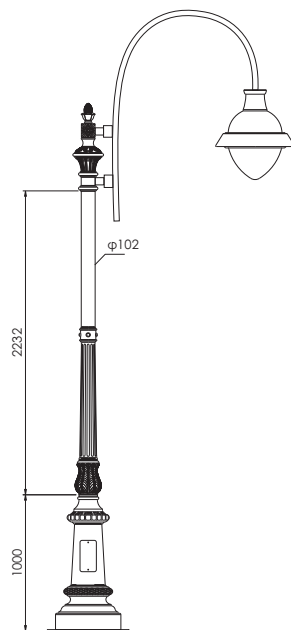

AG-16299

*depending on the model, available upon request in addition to the standard colour: matte black/matte grey/dark grey/dark brown/matte coffee and other RAL colours.

AG-16339



COLUMN: high-end die-cast aluminium alloy with anti-corrosion protection and UV resistant powder coating

CONNECTOR: made of hot-dip galvanised, surface protected against corrosion

LUMINAIRE:
 45-65W LED bulb x 2, E27

SHADE: transparent glass

FINISH:
 matte black in the standard version

DESIGNED FOR:
 streets, car parks, squares, parks, footpaths, etc.

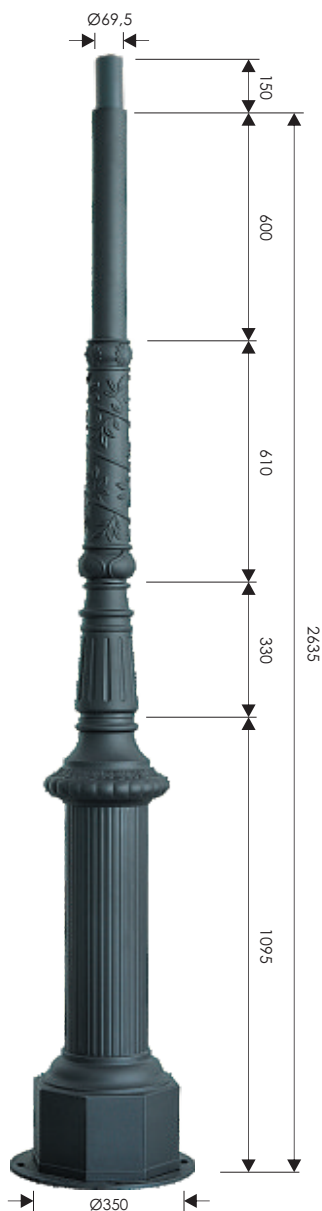

AG-16338

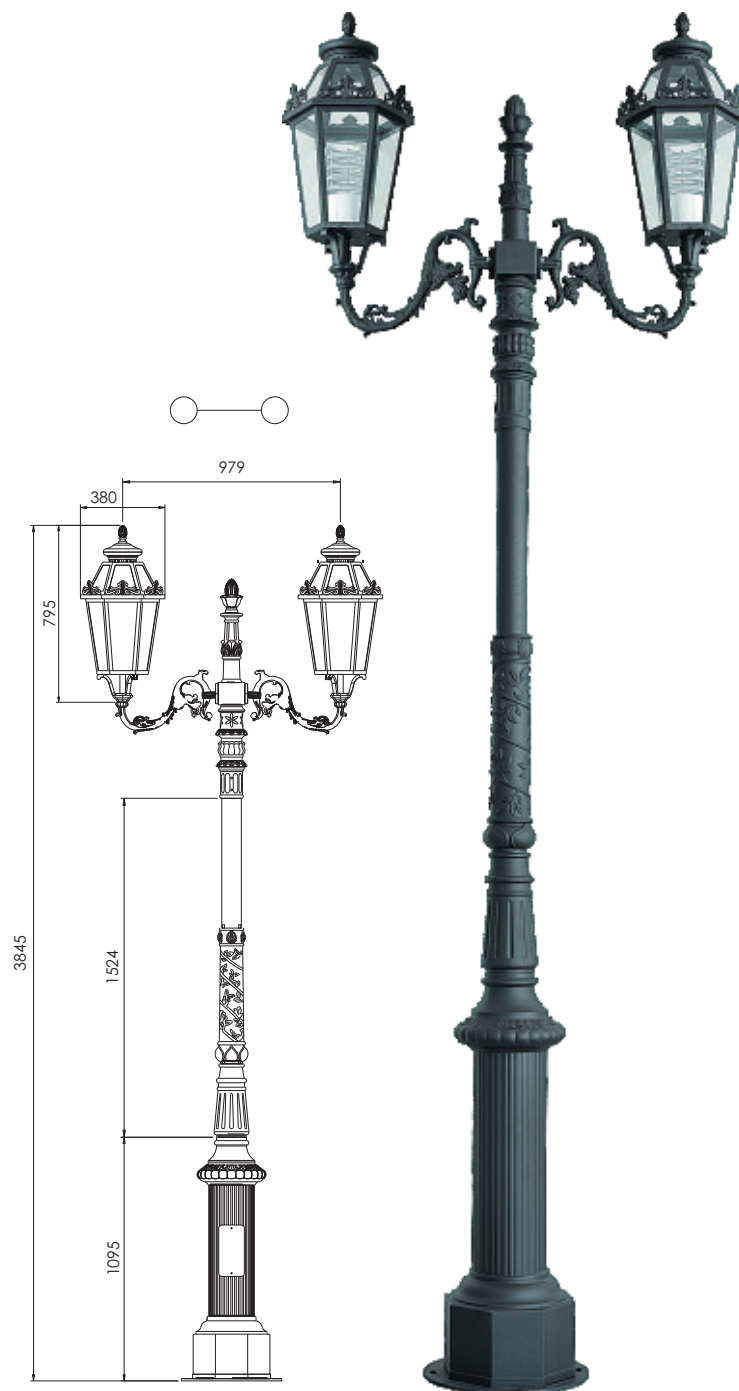

AG-16339

*depending on the model, available upon request in addition to the standard colour: matte black/matte grey/dark grey/dark brown/matte coffee and other RAL colours.

AG-16276



COLUMN: high-end die-cast aluminium alloy with anti-corrosion protection and UV resistant powder coating

FINISH: matte grey in the standard version

CONNECTOR: made of hot-dip galvanised, surface protected against corrosion

SHADE: opal polycarbonate

LUMINAIRE: 45-65W LED bulb x 3, E27

DESIGNED FOR: streets, car parks, squares, parks, footpaths, etc.

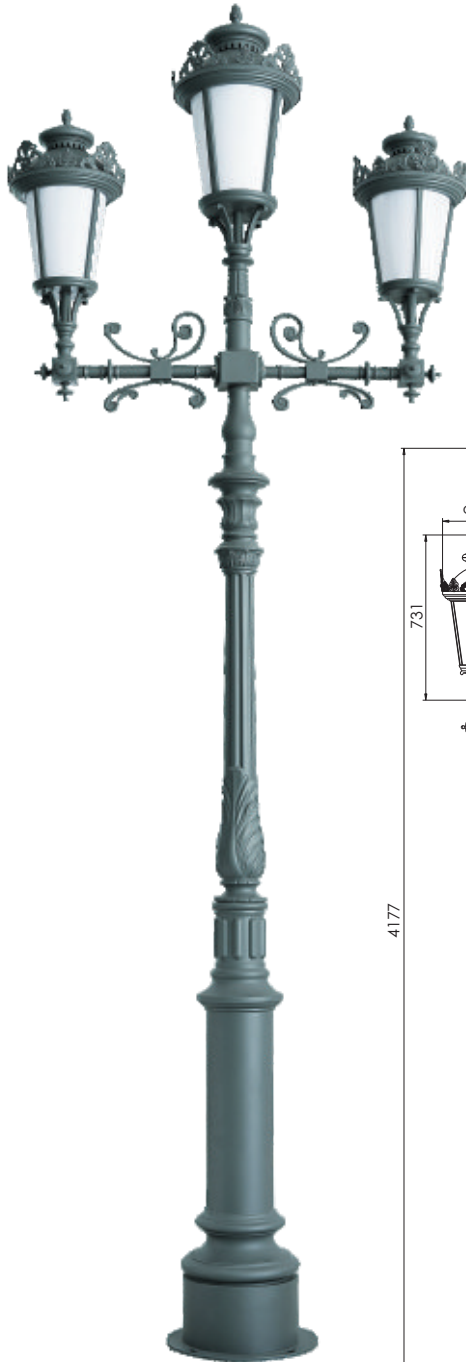

AG-16308

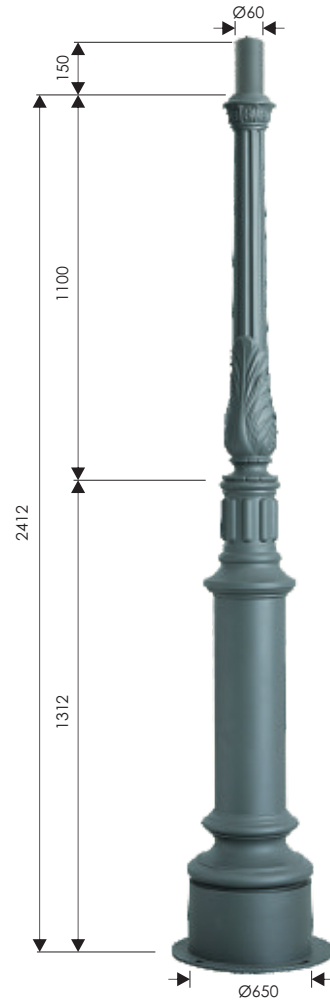
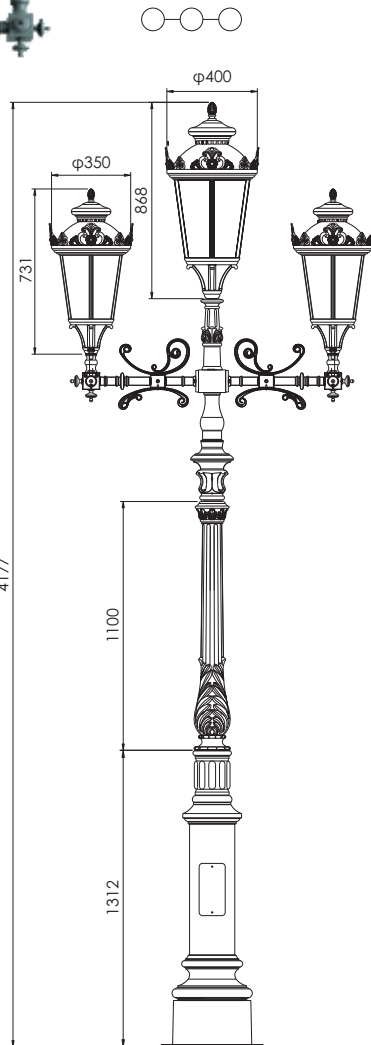

AG-16275

*depending on the model, available upon request in addition to the standard colour: matte black/matte grey/dark grey/dark brown/matte coffee and other RAL colours.

AG-16249



COLUMN: high-end die-cast aluminium alloy with anti-corrosion protection and UV resistant powder coating

FINISH: matte black in the standard version

DESIGNED FOR: streets, car parks, squares, parks, footpaths, etc.

CONNECTOR: made of hot-dip galvanised, surface protected against corrosion

SHADE: opal polycarbonate

LUMINAIRE: 45-65W LED bulb x 4, E27

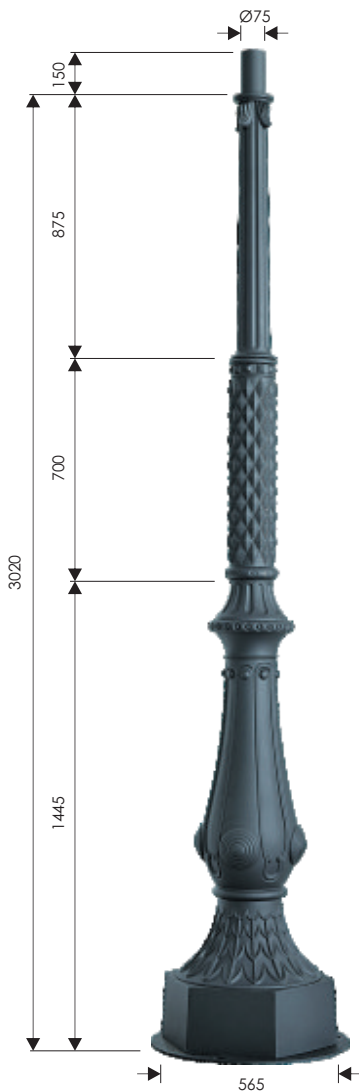

AG-16248

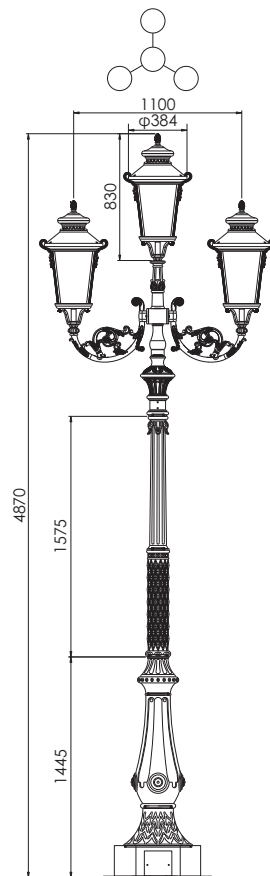

AG-16249

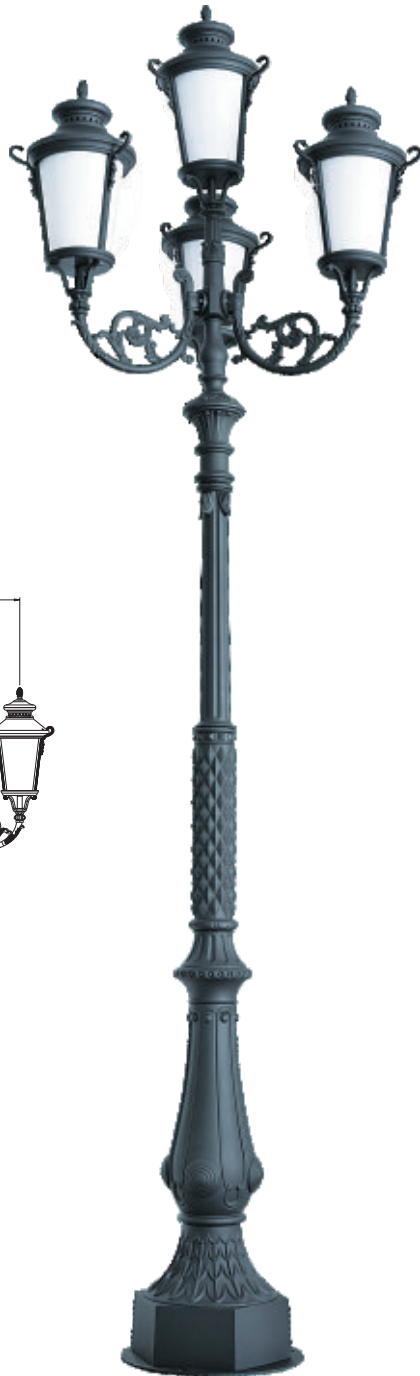

*w zależności od modelu, oprócz koloru w standardzie, dostępne na zamówienie: matowy czarny/matowy szary/ciemny szary/ciemny brązowy/matowy kawowy oraz inne kolory z palety RAL.

AG-16206



COLUMN: high-end die-cast aluminium alloy with anti-corrosion protection and UV resistant powder coating

FINISH: matte black in the standard version

CONNECTOR: made of hot-dip galvanised, surface protected against corrosion

SHADE: opal polycarbonate

LUMINAIRE: 65-85W LED bulb x 5, E27

DESIGNED FOR: streets, car parks, squares, parks, footpaths, etc.

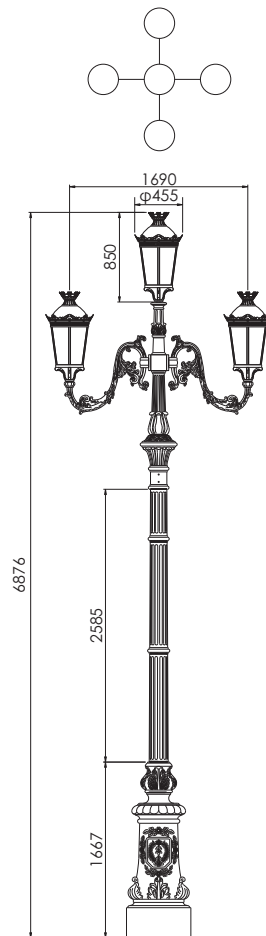
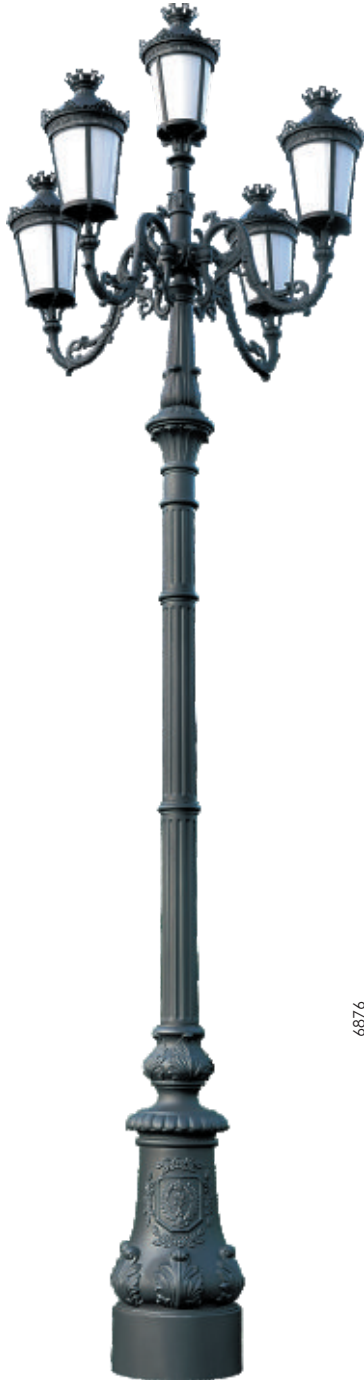

AG-16206

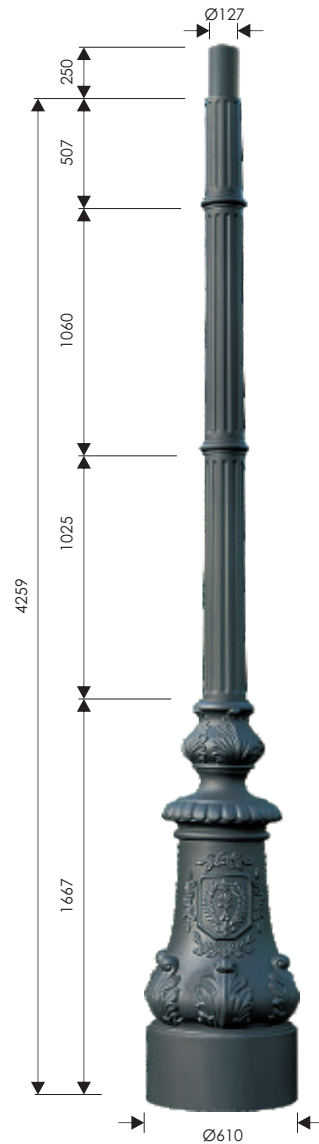

AG-16205

*depending on the model, available upon request in addition to the standard colour: matte black/matte grey/dark grey/dark brown/matte coffee and other RAL colours.



The heritage columns and luminaires can be put together in any combination whatsoever, with only the mounting diameter having to be the same.



We offer a dozen or so various columns and luminaires. For those interested, we have compiled our proposal in electronic version, which can be downloaded from our website.



Presidential Palace - Warsaw

09

Fibreglass Flagpoles

The fibreglass flagpoles are made from a single component (tube), which is tapered towards the top. They are installed in a concrete base using a hinge anchor. The hinge makes the installation easier, enabling to lay the flagpole on the ground, e.g. during maintenance. A system of screws makes it possible to adjust the vertical position of the flagpole.



FIBREGLASS FLAGPOLE WITH LOCKABLE HALYARD AND WINDTRACKER

The halyard runs inside the flagpole. In addition, the flagpole is equipped with a horizontal rotary arm. It prevents the flag from being wrapped around the flagpole and provides an optimal way to highlight the flag slogan.

The price includes: flagpole, white flat DOME FINIAL, rotary head, halyard, swivel, lock, jib (windtracker), weight, clamps (x5), mounting anchor.

Our flagpoles are available in any RAL colour.

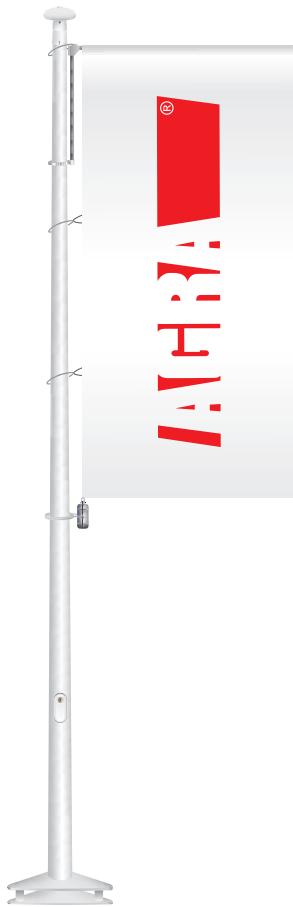

FINIALS



*also available in silver and gold colours

**also available in white and gold colours

FITTING AND FLYING THE FLAG

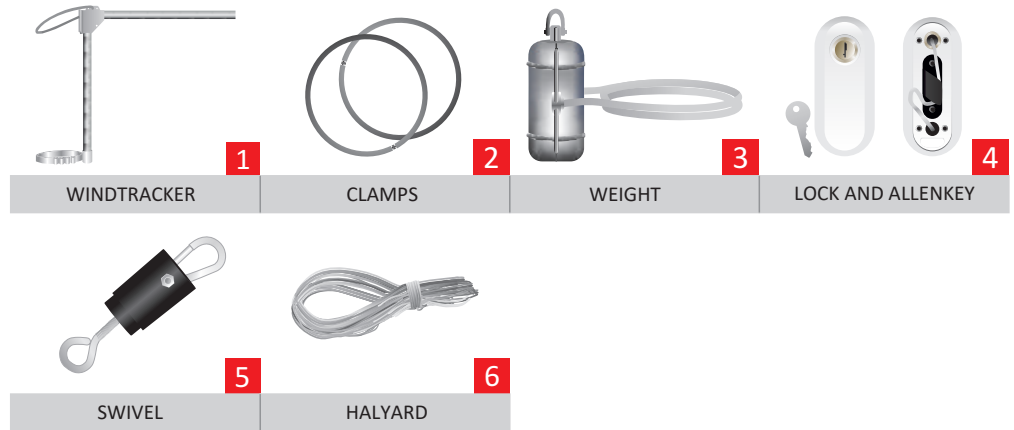

GROUND INSTALLATION



Height (m)	6	7	8	9	10	11	12
Base diameter (mm)	115	115	115	115	145	145	145
Top diameter (mm)	65	65	65	65	65	65	65
Net weight without accessories (mm)	10.8	14.2	15.2	19.9	21.8	25.6	29.4
Maximum flag size (cm)	150x400	150x400	150x500	150x500	150x600	150x600	150x700

FIBREGLASS FLAGPOLE WITH LOCKABLE HALYARD

The halyard runs inside the flagpole; the cleat is lockable with a key. This prevents the flag from being stolen and deadens the noise of the halyard beating against the flagpole.

The price includes: flagpole, white flat dome finial, rotary head, halyard, swivel, lock, weight, clamps (x3) and mounting anchor.

Our flagpoles are available in any RAL colour.

FINIALS



*also available in silver and gold colours

**also available in white and gold colours

FITTING AND FLYING THE FLAG



GROUND INSTALLATION



Height (m)	6	7	8	9	10	11	12
Base diameter (mm)	115	115	115	115	145	145	145
Top diameter (mm)	65	65	65	65	65	65	65
Net weight without accessories (mm)	10.8	14.2	15.2	19.9	21.8	25.6	29.4
Maximum flag size (cm)	150x400	150x400	150x500	150x500	150x600	150x600	150x700

STANDARD FIBREGLASS FLAGPOLE

The halyard runs outside the flagpole and is attached to a cleat mounted at approx. 1.5m above ground level

The price includes: flagpole, white flat dome finial, rotary head, halyard, cleat and mounting anchor.

Our flagpoles are available in any RAL colour.



FINIALS



*also available in silver and gold colours

**also available in white and gold colours

FITTING AND FLYING THE FLAG

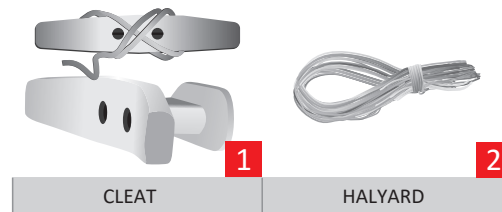

GROUND INSTALLATION



Height (m)	6	7	8	9	10	11	12
Base diameter (mm)	115	115	115	115	145	145	145
Top diameter (mm)	65	65	65	65	65	65	65
Net weight without accessories (mm)	10.8	14.2	15.2	19.9	21.8	25.6	29.4
Maximum flag size (cm)	150x400	150x400	150x500	150x500	150x600	150x600	150x700

BANNER FIBREGLASS FLAGPOLE

In this model, the flagpole comes with no halyard.

The banner flagpole is provided with a fixed horizontal rotary arm, which keeps the flag always legible. The flagpole needs to be laid on the ground before the flag can be fitted or removed.

The price includes: flagpole, white flat dome finial, rotary head, jib (banner), weight, clamps (x5), mounting anchor.

Our flagpoles are available in any RAL colour.

FINIALS



*also available in silver and gold colours

**also available in white and gold colours

FITTING AND FLYING THE FLAG

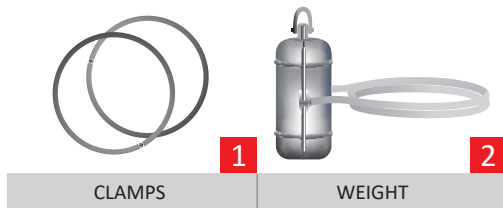

GROUND INSTALLATION

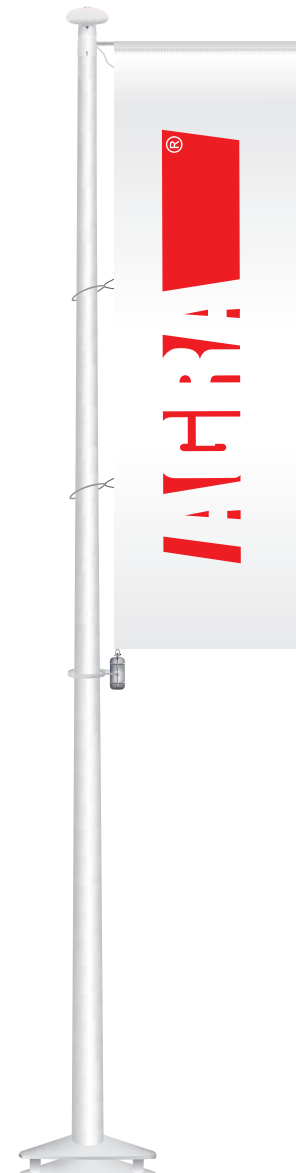

Height (m)	6	7	8	9	10	11	12
Base diameter (mm)	115	115	115	115	145	145	145
Top diameter (mm)	65	65	65	65	65	65	65
Net weight without accessories (mm)	10.8	14.2	15.2	19.9	21.8	25.6	29.4
Maximum flag size (cm)	150x400	150x400	150x500	150x500	150x600	150x600	150x700

FIBREGLASS FLAGPOLE WITH WINCH

The halyard runs inside the flagpole. The flag is raised and lowered using a winch mechanism incorporated into the flagpole.

The price includes: flagpole, white flat dome finial, rotary head, halyard, swivel, winch, weight, clamps (x3) and mounting anchor.

Our flagpoles are available in any RAL colour.



FINIALS



*also available in silver and gold colours

**also available in white and gold colours

FITTING AND FLYING THE FLAG

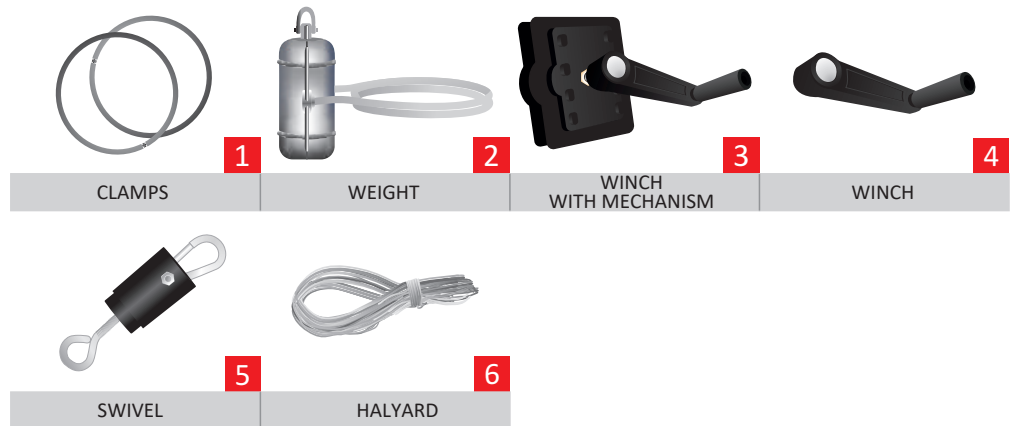

GROUND INSTALLATION

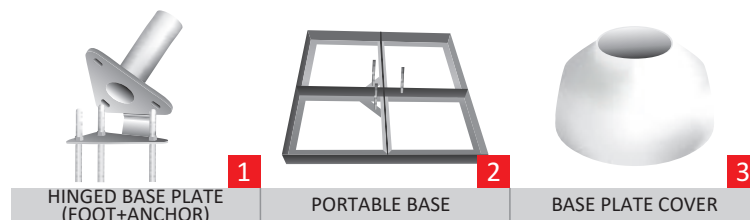

Height (m)	6	7	8	9	10	11	12
Base diameter (mm)	115	115	115	115	145	145	145
Top diameter (mm)	65	65	65	65	65	65	65
Net weight without accessories (mm)	10.8	14.2	15.2	19.9	21.8	25.6	29.4
Maximum flag size (cm)	150x400	150x400	150x500	150x500	150x600	150x600	150x700

FIBREGLASS FLAGPOLE WITH WINCH AND WINDTRACKER

The halyard runs inside the flagpole. In addition, the flagpole is equipped with a horizontal rotary arm (windtracker). It prevents the flag from being wrapped around the flagpole and provides an optimal way to highlight the flag slogan.

The price includes: flagpole, white flat dome finial, rotary head, halyard, swivel, winch, jib (windtracker), weight, clamps (x5) and mounting anchor.

Our flagpoles are available in any RAL colour.

FINIALS



*also available in silver and gold colours

**also available in white and gold colours

FITTING AND FLYING THE FLAG



GROUND INSTALLATION

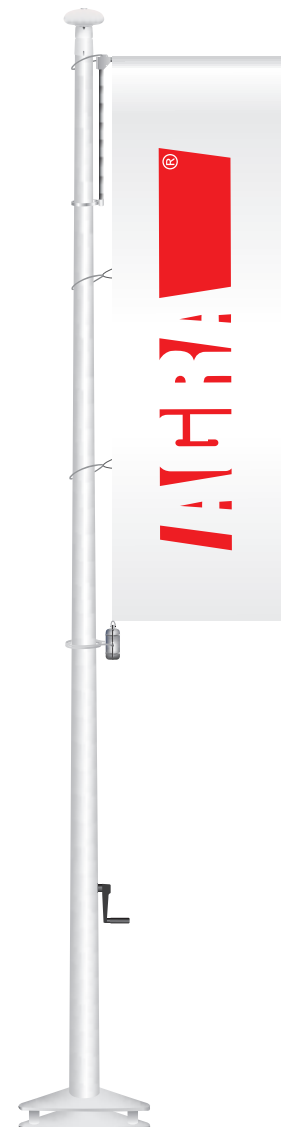
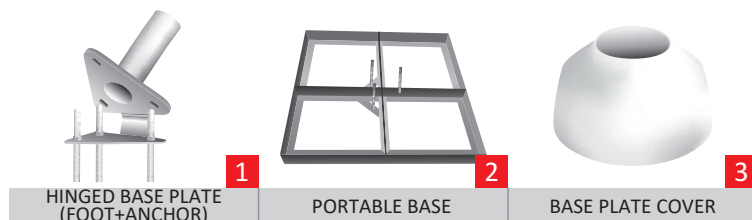

Height (m)	6	7	8	9	10	11	12
Base diameter (mm)	115	115	115	115	145	145	145
Top diameter (mm)	65	65	65	65	65	65	65
Net weight without accessories (mm)	10.8	14.2	15.2	19.9	21.8	25.6	29.4
Maximum flag size (cm)	150x400	150x400	150x500	150x500	150x600	150x600	150x700



TVP - Warsaw

10

Aluminium Flagpoles

Depending on their height, the aluminium flagpoles are made up of two, three or four aluminium tubes that are pushed together using sleeves and aluminium rings. The flagpoles are installed in a concrete base using a mounting hinge or fixing sleeve. The hinge makes the installation easier and makes it possible to lay the flagpole on the ground, e.g. during maintenance. A system of screws makes it possible to adjust the vertical position of the flagpole.

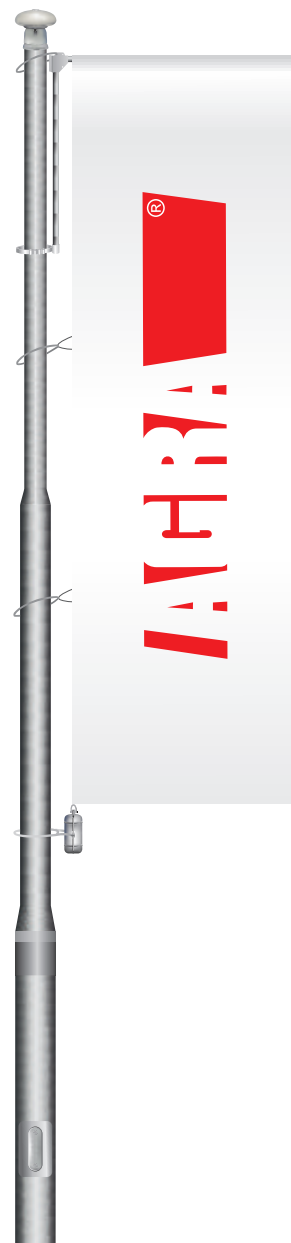

ALUMINIUM FLAGPOLE WITH LOCABLE HALYARD AND WINDTRACKER

The halyard runs inside the flagpole. In addition, the flagpole is equipped with a horizontal rotary arm. It prevents the flag from being wrapped around the flagpole and provides an optimal way to highlight the flag slogan.

The price includes: flagpole, grey flat ball finial, rotary head, halyard, swivel, lock, jib (windtracker), weight, clamps (x5), mounting anchor or fixing sleeve.

Our flagpoles are available in any RAL colour.

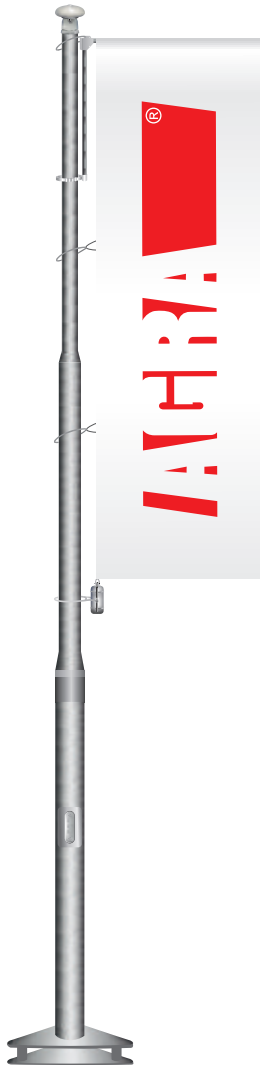

FINIALS



FITTING AND FLYING THE FLAG

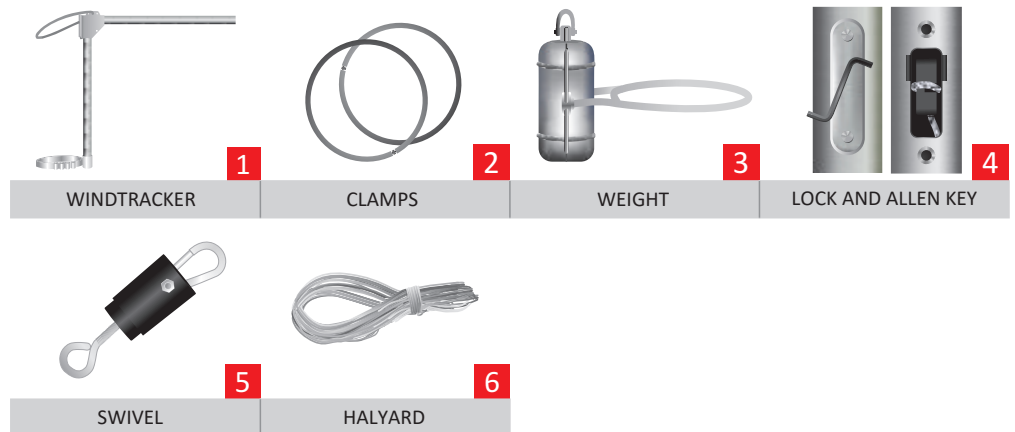

GROUND INSTALLATION

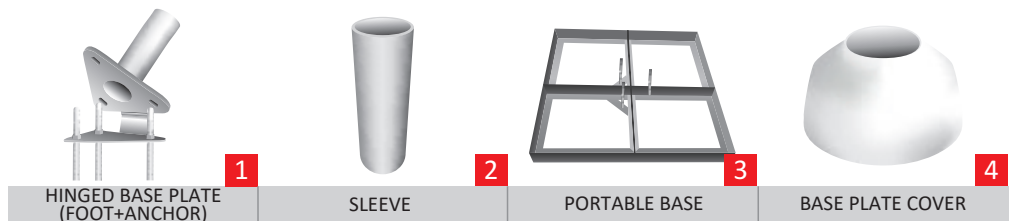

Height (m)	6	7	8	9	10	11	12
Number of sections (pcs)	2	2	2	2	3	3	3
Section diameter (mm)	82.5/67.5	82.5/67.5	82.5/67.5	82.5/67.5	98.5/82.5/67.5	98.5/82.5/67.5	98.5/82.5/67.5
Wall thickness (mm)	3.5/3	3.5/3	3.5/3	3.5/3	4/3.5/3	4/3.5/3	4/3.5/3
Net weight without accessories (mm)	13	15.6	18.2	21.5	25.7	29.5	31.4
Maximum flag size (cm)	150x400	150x400	150x500	150x500	150x600	150x600	150x700

ALUMINIUM FLAGPOLE WITH LOCKABLE HALYARD

The halyard runs inside the flagpole. The cleat is protected with a lock, which prevents the flag from being stolen and deadens the noise of the halyard beating against the flagpole

The price includes: flagpole, grey flat dome finial, rotary head, halyard, swivel, lock, weight, clamps (x3), mounting anchor or fixing sleeve.

Our flagpoles are available in any RAL colour.

FINIALS



*also available in silver and gold colours

**also available in white and gold colours

FITTING AND FLYING THE FLAG

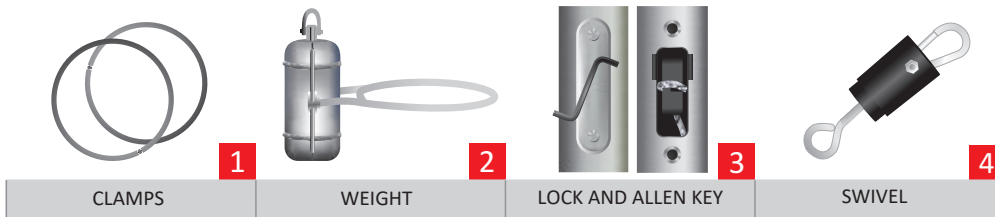

GROUND INSTALLATION

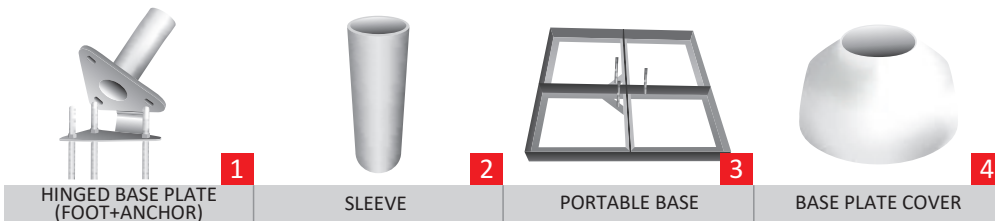

Height (m)	6	7	8	9	10	11	12
Number of sections (pcs)	2	2	2	2	3	3	3
Section diameter (mm)	82.5/67.5	82.5/67.5	82.5/67.5	82.5/67.5	98.5/82.5/67.5	98.5/82.5/67.5	98.5/82.5/67.5
Wall thickness (mm)	3.5/3	3.5/3	3.5/3	3.5/3	4/3.5/3	4/3.5/3	4/3.5/3
Net weight without accessories (mm)	13	15.6	18KEY.,2	21.5	25.7	29.5	31.4
Maximum flag size (cm)	150x400	150x400	150x500	150x500	150x600	150x600	150x700

STANDARD ALUMINIUM FLAGPOLE

In this model, the halyard runs outside the flagpole and is attached to a cleat mounted at approx. 1.5m above ground level.

The price includes: flagpole, grey flat dome finial, rotary head, halyard, cleat, mounting anchor or fitting sleeve.

Our flagpoles are available in any RAL colour.

FINIALS



*also available in silver and gold colours

**also available in white and gold colours

FITTING AND FLYING THE FLAG

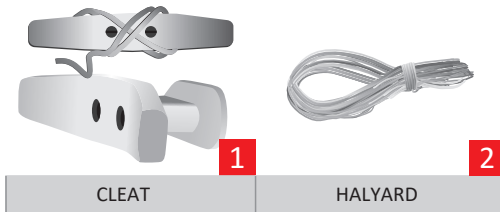

GROUND INSTALLATION

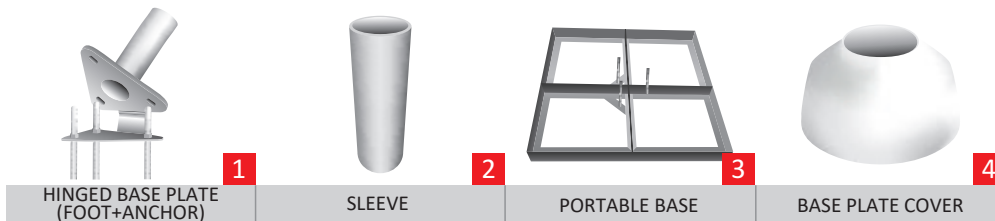

Height (m)	6	7	8	9	10	11	12
Number of sections (pcs)	2	2	2	2	3	3	3
Section diameter (mm)	82.5/67.5	82.5/67.5	82.5/67.5	82.5/67.5	98.5/82.5/67.5	98.5/82.5/67.5	98.5/82.5/67.5
Wall thickness (mm)	3.5/3	3.5/3	3.5/3	3.5/3	4/3.5/3	4/3.5/3	4/3.5/3
Net weight without accessories (mm)	13	15.6	18.2	21.5	25.7	29.5	31.4
Maximum flag size (cm)	150x400	150x400	150x500	150x500	150x600	150x600	150x700

ALUMINIUM BANNER FLAGPOLE

In this model, the banner flagpole comes with no halyard.
 The flagpole is provided with a fixed horizontal rotary arm, which keeps the flag always legible. The flagpole needs to be laid on the ground before the flag can be fitted or removed.

The price includes: flagpole, grey flat dome finial, rotary head, halyard (banner), weight, clamps (x5), mounting hinge or fixing sleeve.

Our flagpoles are available in any RAL colour.

FINIALS



*also available in silver and gold colours

**also available in white and gold colours

FITTING AND FLYING THE FLAG

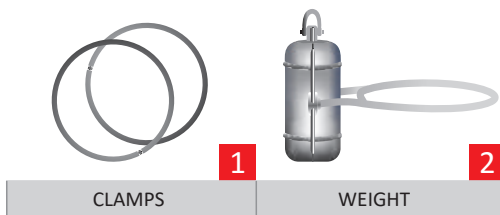

GROUND INSTALLATION

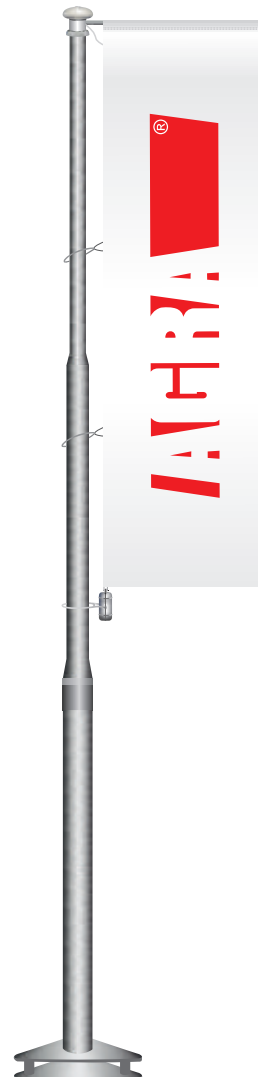
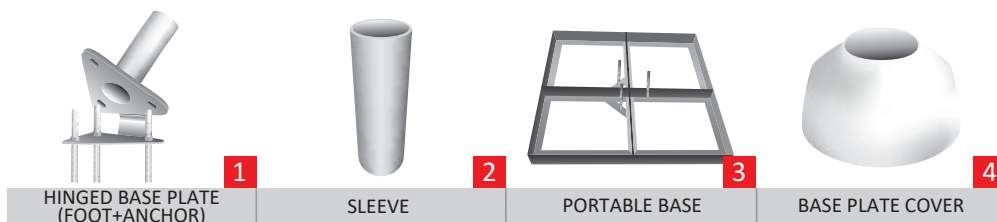

Height (m)	6	7	8	9	10	11	12
Number of sections (pcs)	2	2	2	2	3	3	3
Section diameter (mm)	82.5/67.5	82.5/67.5	82.5/67.5	82.5/67.5	98.5/82.5/67.5	98.5/82.5/67.5	98.5/82.5/67.5
Wall thickness (mm)	3.5/3	3.5/3	3.5/3	3.5/3	4/3.5/3	4/3.5/3	4/3.5/3
Net weight without accessories (mm)	13	15.6	18.2	21.5	25.7	29.5	31.4
Maximum flag size (cm)	150x400	150x400	150x500	150x500	150x600	150x600	150x700

ALUMINIUM FLAGPOLE WITH WINCH

The halyard runs inside the flagpole. The flag is raised and lowered using a mechanism incorporated into the flagpole.

The price includes: flagpole, grey flat ball finial, rotary head, halyard, swivel, winch, weight, clamps (x3), mounting anchor.

Our flagpoles are available in any RAL colour.



FINIALS



FITTING AND FLYING THE FLAG

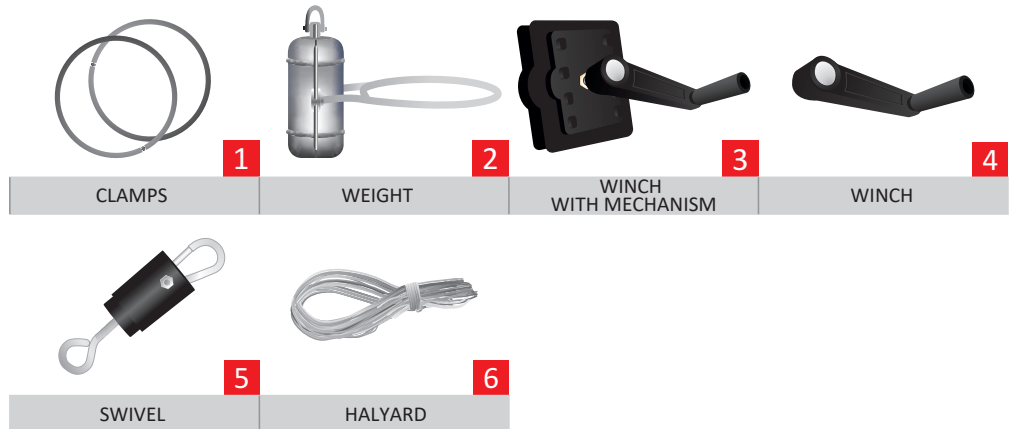

GROUND INSTALLATION

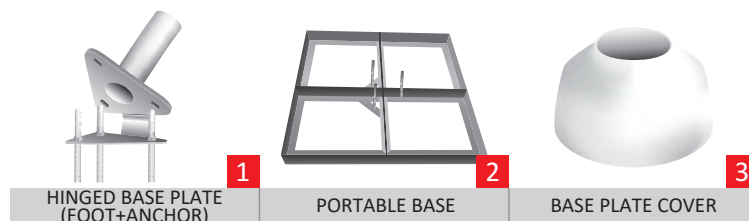

Height (m)	6	7	8	9	10	11	12
Number of sections (pcs)	4	4	4	4	4	4	4
Section diameter (mm)	120/98.5/ 82.5/67.5	120/98.5/ 82.5/67.5	120/98.5/ 82.5/67.5	120/98.5/ 82.5/67.5	120/98.5/ 82.5/67.5	120/98.5/ 82.5/67.5	120/98.5/ 82.5/67.5
Wall thickness (mm)	5/4/3.5/3	5/4/3.5/3	5/4/3.5/3	5/4/3.5/3	5/4/3.5/3	5/4/3.5/3	5/4/3.5/3
Net weight without accessories (mm)	25.8	26.4	27.8	29.8	30.6	31.5	34.6
Maximum flag size (cm)	150x400	150x400	150x500	150x500	150x600	150x600	150x700

ALUMINIUM FLAGPOLE WITH WINCH AND WINDTRACKER

The halyard runs inside the flagpole. In addition, the flagpole is equipped with a horizontal rotary arm. It prevents the flag from being wrapped around the flagpole and provides an optimal way to highlight the flag slogan.

The price includes: flagpole, grey flat ball finial, rotary head, halyard, swivel, lock, jib (windtracker), weight, clamps (x5) and mounting anchor.

Our flagpoles are available in any RAL colour.

FINIALS



*also available in silver and gold colours

**also available in white and gold colours

FITTING AND FLYING THE FLAG

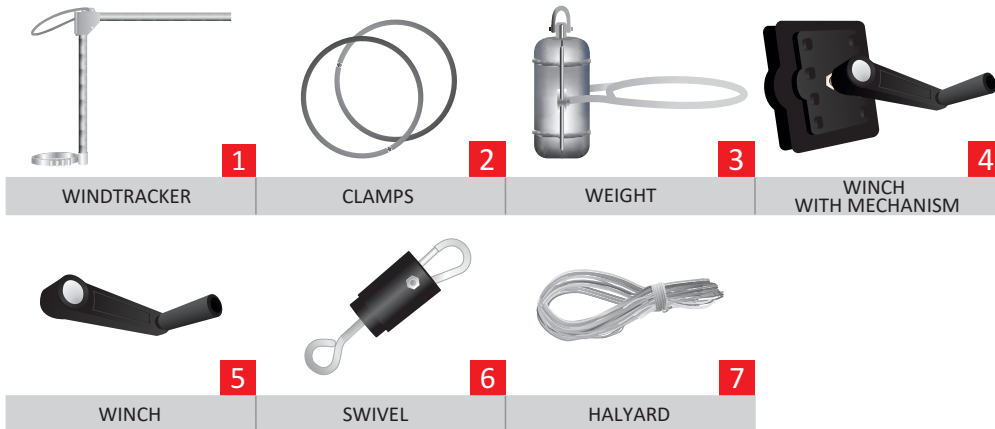

GROUND INSTALLATION

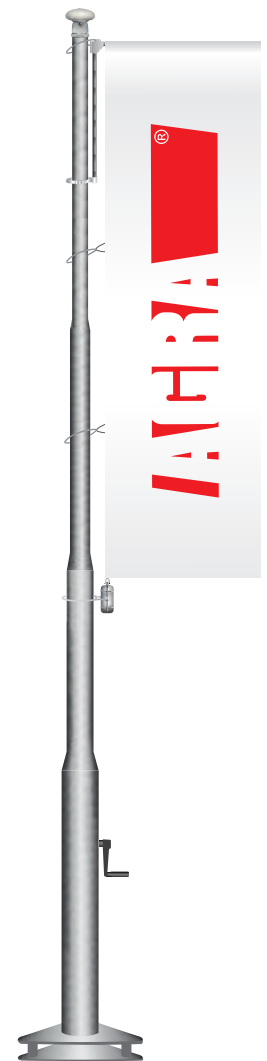
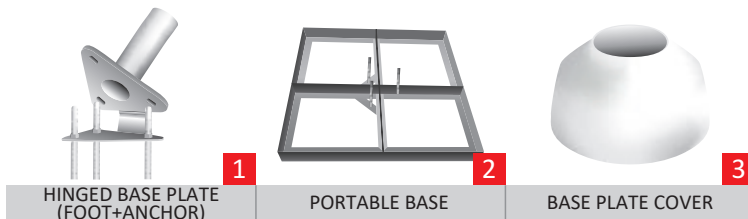

Height (m)	6	7	8	9	10	11	12
Number of sections (pcs)	4	4	4	4	4	4	4
Section diameter (mm)	120/98.5/ 82.5/67.5	120/98.5/ 82.5/67.5	120/98.5/ 82.5/67.5	120/98.5/ 82.5/67.5	120/98.5/ 82.5/67.5	120/98.5/ 82.5/67.5	120/98.5/ 82.5/67.5
Wall thickness (mm)	5/4/3.5/3	5/4/3.5/3	5/4/3.5/3	5/4/3.5/3	5/4/3.5/3	5/4/3.5/3	5/4/3.5/3
Net weight without accessories (mm)	25.8	26.4	27.8	29.8	30.6	31.5	34.6
Maximum flag size (cm)	150x400	150x400	150x500	150x500	150x600	150x600	150x700



Russia - Moscow



Hungary - Budapest

11

ECO Aluminium Flagpoles

Depending on their height, the aluminium flagpoles are made up of two, three or four aluminium tubes that are pushed together using sleeves and aluminium rings. The flagpoles are installed in a concrete base using a mounting hinge or fixing sleeve. The hinge makes the installation easier and makes it possible to lay the flagpole on the ground, e.g. during maintenance. A system of screws makes it possible to adjust the vertical position of the flagpole.



ECO ALUMINIUM FLAGPOLE WITH LOCKABLE HALYARD AND WINDTRACKER

The halyard runs inside the flagpole. In addition, the flagpole is equipped with a horizontal rotary arm. It prevents the flag from being wrapped around the flagpole and provides an optimal way to highlight the flag slogan.

The price includes: flagpole, grey flat dome finial, rotary head, halyard, swivel, lock, jib (windtracker), weight, clamps (x5), mounting anchor or fixing sleeve.

Our flagpoles are available in any RAL colour.

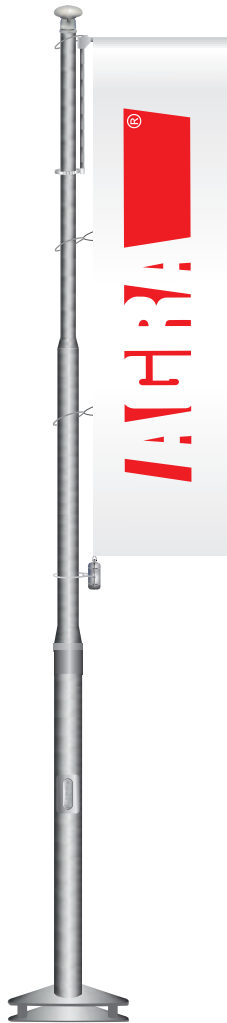

FINIALS



FITTING AND FLYING THE FLAG

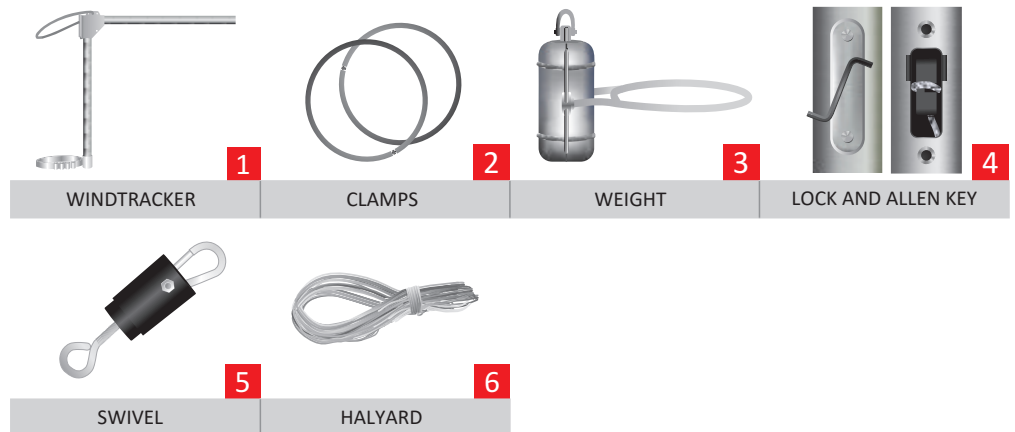

GROUND INSTALLATION

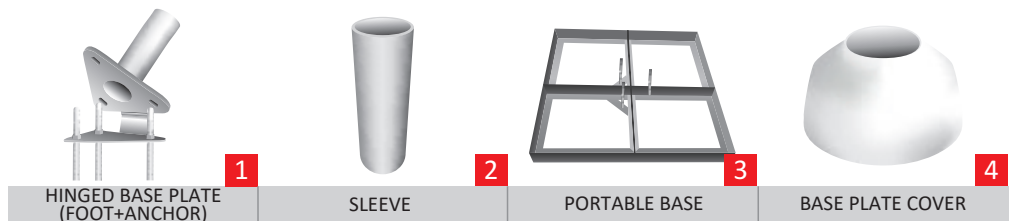

Height (m)	4	5	6	7	8	9	10	12
Number of sections (pcs)	2	2	2	2	3	3	4	4
Section diameter (mm)	66/50	66/50	66/50	66/50	80/66/50	80/66/50	98,5/80/66/50	98.5/80/66/50
Wall thickness (mm)	2.5/2	2.5/2	2.5/2	2.5/2	3/2.5/2	3/2.5/2	4/3/2.5/2	4/3/2.5/2
Net weight without accessories	7	7.8	8.6	12.2	13.6	14.8	20.8	22.9
Maximum flag size (cm)	100x300	100x400	120x400	120x400	120x400	150x500	150x500	150/600

ECO ALUMINIUM FLAGPOLE WITH LOCKABLE HALYARD

In this model, the halyard runs inside the flagpole. The cleat is lockable with a key. This prevents the flag from being stolen and deadens the noise of the halyard beating against the flagpole.

The price includes: flagpole, white flat ball finial, rotary head, halyard, swivel, lock, weight, clamps (x3), mounting anchor or fitting sleeve.

Our flagpoles are available in any RAL colour.

FINIALS



*also available in silver and gold colours

**also available in white and gold colours

FITTING AND FLYING THE FLAG

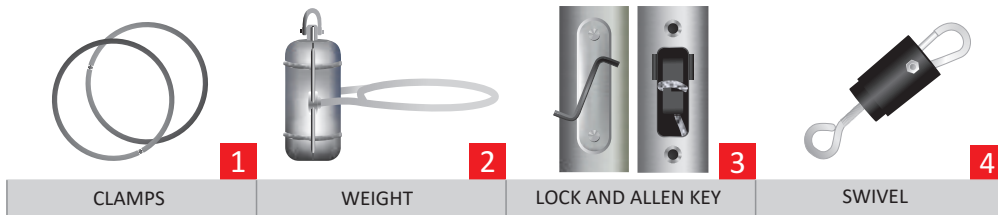

GROUND INSTALLATION

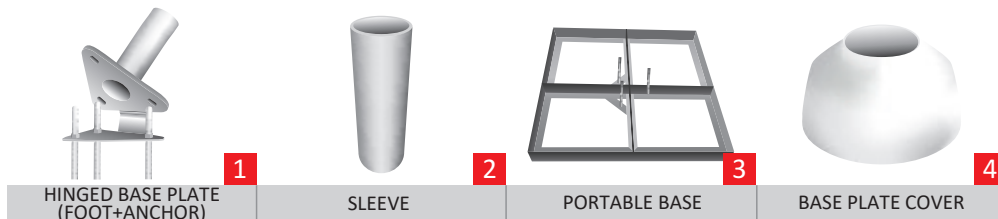

Height (m)	4	5	6	7	8	9	10	12
Number of sections (pcs)	2	2	2	2	3	3	4	4
Section diameter (mm)	66/50	66/50	66/50	66/50	80/66/50	80/66/50	98.5/80/66/50	98.5/80/66/50
Wall thickness (mm)	2.5/2	2.5/2	2.5/2	2.5/2	3/2./2	3/2.5/2	4/3/2.5/2	4/3/2.5/2
Net weight without accessories	7	7.8	8.6	12.2	13.6	14.8	20.8	22.9
Maximum flag size (cm)	100x300	100x400	120x400	120x400	120x400	150x500	150x500	150/600

ECO STANDARD ALUMINIUM FLAGPOLE

In this model, the halyard runs outside the flagpole and is attached to a cleat mounted at approx. 1.5m above ground level.

The price includes: flagpole, grey flat dome finial, rotary head, halyard, cleat, mounting anchor or fitting sleeve.

Our flagpoles are available in any RAL colour.



FINIALS



*also available in silver and gold colours

**also available in white and gold colours

FITTING AND FLYING THE FLAG

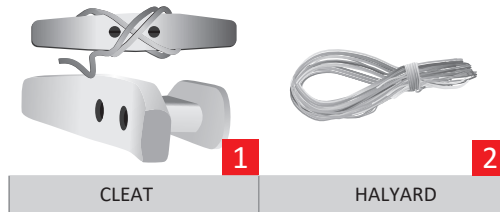

GROUND INSTALLATION

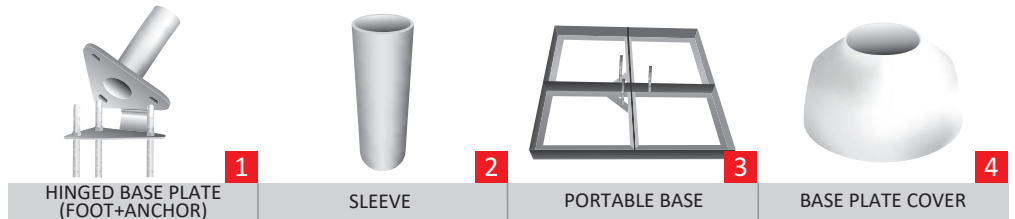

Height (m)	4	5	6	7	8	9	10	12
Number of sections (pcs)	2	2	2	2	3	3	4	4
Section diameter (mm)	66/50	66/50	66/50	66/50	80/66/50	80/66/50	98.5/80/66/50	98.5/80/66/50
Wall thickness (mm)	2.5/2	2.5/2	2.5/2	2.5/2	3/2.5/2	3/2.5/2	4/3/2.5/2	4/3/2.5/2
Net weight without accessories	7	7.8	8.6	12.2	13.6	14.8	20.8	22.9
Maximum flag size (cm)	100x300	100x400	120x400	120x400	120x400	150x500	150x500	150/600

ECO ALUMINIUM BANNER FLAGPOLE

In this model, the banner flagpole comes with no halyard.
 The flagpole is provided with a fixed horizontal rotary arm, which keeps the flag always legible. The flagpole needs to be laid on the ground before the flag can be fitted or removed.

The price includes: flagpole, white flat dome finial, rotary head, jib (banner), weight, clamps (x5), mounting anchor or fitting sleeve.

Our flagpoles are available in any RAL colour.

FINIALS



*also available in silver and gold colours

**also available in white and gold colours

FITTING AND FLYING THE FLAG

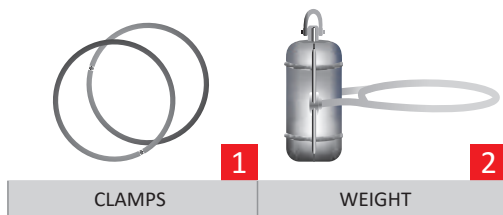

GROUND INSTALLATION

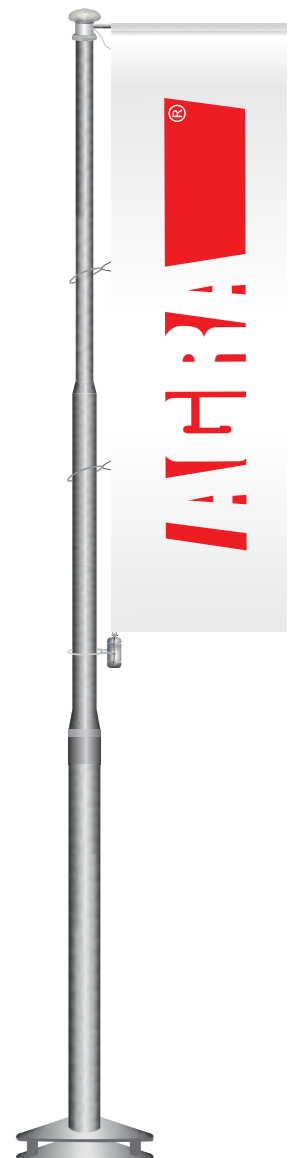
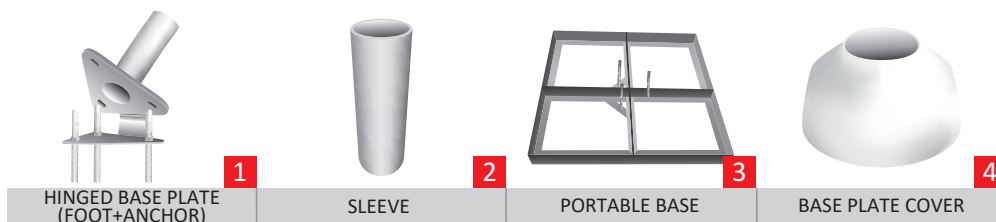

Height (m)	4	5	6	7	8	9	10	12
Number of sections (pcs)	2	2	2	2	3	3	4	4
Section diameter (mm)	66/50	66/50	66/50	66/50	80/66/50	80/66/50	98.5/80/66/50	98.5/80/66/50
Wall thickness (mm)	2.5/2	2.5/2	2.5/2	2.5/2	3/2.5/2	3/2.5/2	4/3/2.5/2	4/3/2.5/2
Net weight without accessories	7	7.8	8.6	12.2	13.6	14.8	20.8	22.9
Maximum flag size (cm)	100x300	100x400	120x400	120x400	120x400	150x500	150x500	150/600

12

Telescoping Flagpole

Depending on their height, the aluminium telescoping flagpoles are made up of two, three or four aluminium tubes.

Their height is steplessly adjustable from 3m to 6m. The flagpoles are put up using tire mounts or portable bases. Their main advantage is that they are easy to install and dismantle as well as, due to their small size, convenient to transport .



NATO complex - Bydgoszcz

TELESCOPIC FLAGPOLE

In this model, the flagpole comes with no halyard. The flagpole is provided with a fixed horizontal rotary arm, which keeps the flag always legible. The flagpole needs to be laid on the ground before the flag can be fitted or removed.

The price includes: flagpole, grey flat dome finial, rotary head, jib (banner), weight, clamps (x3), tire mount, water stand or portable concrete base.

Our flagpoles are available in any RAL colour.

FINIALS



1

SMALL GREY DOME FINIAL



2

HEAD

FITTING AND FLYING THE FLAG

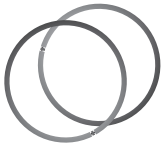

1

CLAMPS

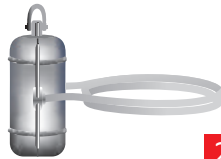

2

WEIGHT

TRANSPORT



1

CASE

GROUND INSTALLATION



1

TIRE MOUNT

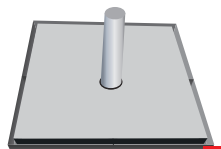

2

CONCRETE BASE



3

WATER STAND



4

CROSS MOUNTED



5

ROOT

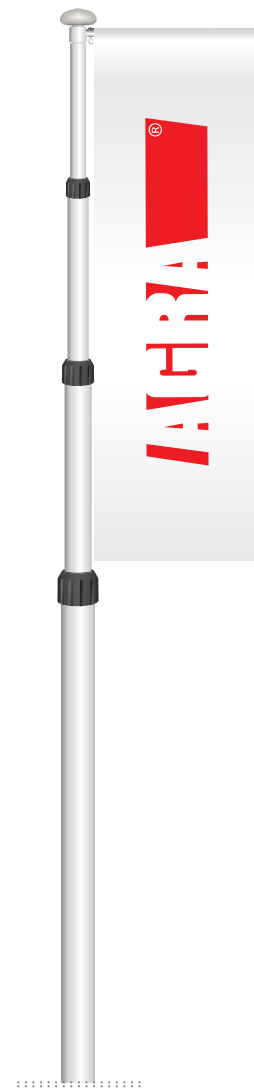

Height (m)	3m to 6m
Number of sections (pcs)	3 or 4
Section diameter (mm)	58/50/42/34
Wall thickness (mm)	2/2/1.5/1.5
Net weight without accessories (mm)	6
Maximum flag size (cm)	100x300

SYMBOLS

	CE marking
IP	Ingress protection rating
IK	IK rating (protection against mechanical impacts)
	ISO 9001 compliant quality management system
	14001 compliant quality management system
	Easy installation
	Two-year manufacturer warranty
	Five-year manufacturer warranty
	Ten-year manufacturer warranty
	LED lighting



Flagpoles and flags
Lighting columns and LED luminaires
ul. Kolejowa 3, 95-082 Dobroń
tel: +48 43-67-72-601
tel: +48 43-67-12-076
fax: +48 43-67-72-028

● Flagpoles and flags

FLAGPOLES:
e-mail: jacek@agra-dobron.pl
mobile: +48 501-960-771

e-mail: sebastian@agra-dobron.pl
mobile: +48 697-092-616

FLAGS:
e-mail: flagi@agra-dobron.pl
mobile: +48 697-092-615

SUPPORT:
e-mail: serwis@agra-dobron.pl
mobile: +48 697-050-980

● Lighting columns and LED luminaires
e-mail: biuro@agra-dobron.pl
mobile: +48 509-287-080

e-mail: techniczny@agra-dobron.pl
mobile: +48 601-995-805

www.agra-dobron.pl



www.agra-dobron.pl

LIGHTING COLUMNS LED LUMINAIRES FLAGPOLES FLAGS